

SPACER SUPPORT

- ◆ MATERIAL: NYLON 66 (UL)
- ◆ FLAME CLASS: 94V-2/94V-0
- ◆ COLOR: NATURAL/BLACK
- ◆ UNIT: mm

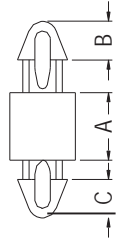

P.C.B Ø2.0
THICKNESS 1.6



CHASSIS Ø2.0
THICKNESS: E

PART NO	A	B	C	E	PACKAGE
MADB-3.5	3.5	2.0	2.0	0.9	2000
MADB-6	6.0	1.9	1.9	0.8	

SPACER SUPPORT

- ◆ MATERIAL: NYLON 66 (UL)
- ◆ FLAME CLASS: 94V-2/94V-0
- ◆ COLOR: NATURAL/BLACK
- ◆ UNIT: mm

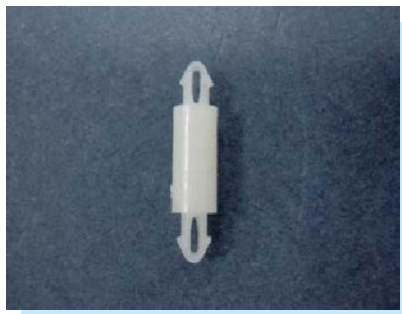

P.C.B Ø2.0
THICKNESS 1.6

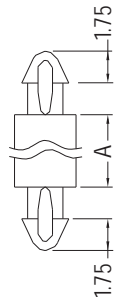

P.C.B Ø2.0
THICKNESS 1.6

P.C.B Ø2.0
THICKNESS 1.6

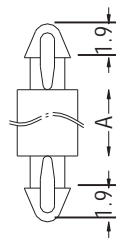

P.C.B Ø2.0
THICKNESS 1.6
FOR MAD-14

PART NO	A	PACKAGE
★ MAD-1.6	1.6	2000
MAD-2.2	2.2	
MAD-3	3.0	
MAD-3.5	3.5	
MAD-4	4.0	
MAD-5	5.0	
MAD-6	6.0	
MAD-6.5	6.5	
MAD-7	7.0	
MAD-8	8.0	
MAD-10S	10.0	
MAD-10	10.5	
MAD-12.5	12.5	
MAD-14	14.0	
MAD-25	25.0	

SPACER SUPPORT

- ◆ MATERIAL: NYLON 66 (UL)
- ◆ FLAME CLASS: 94V-2/94V-0
- ◆ COLOR: NATURAL/BLACK
- ◆ UNIT: mm



HOLE Ø2.0
THICKNESS 1.0

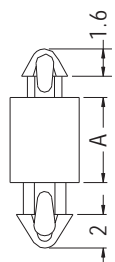

P.C.B Ø2.5
THICKNESS 1.6

PART NO	A	PACKAGE
MAMDA-1.6	1.6	1000
MAMDA-2.5	2.5	
MAMDA-3.2	3.2	
MAMDA-4	4.0	
MAMDA-4.8	4.8	
MAMDA-5.5	5.5	
MAMDA-6.4	6.4	
MAMDA-7	7.0	
MAMDA-7.9	7.9	
MAMDA-9.5	9.5	
MAMDA-10	10.0	
MAMDA-12.7	12.7	

