

SPACER SUPPORT

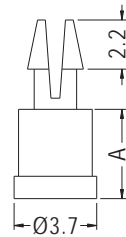

- ◆ MATERIAL: NYLON 66 (UL)
- ◆ FLAME CLASS: 94V-2/94V-0
- ◆ COLOR: NATURAL/BLACK
- ◆ UNIT: mm

P.C.B Ø2.0
THICKNESS 1.2-1.8



PART NO	A	PACKAGE
MS-4	4.0	2000
MS-5	5.0	
★ MS-10	10.0	

SPACER SUPPORT



- ◆ MATERIAL: NYLON 66 (UL)
- ◆ FLAME CLASS: 94V-2/94V-0
- ◆ COLOR: NATURAL/BLACK
- ◆ UNIT: mm

CHASSIS Ø2.2
THICKNESS 1.6

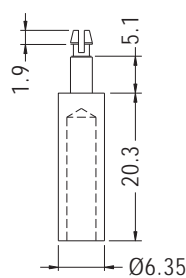

PART NO	PACKAGE
PCLS-25	1000



SPACER SUPPORT



- ◆ MATERIAL: NYLON 66 (UL)
- ◆ FLAME CLASS: 94V-2/94V-0
- ◆ COLOR: NATURAL/BLACK
- ◆ UNIT: mm

P.C.B Ø2.3
THICKNESS 1.6

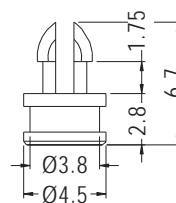

PART NO	PACKAGE
MSB-2.8	1000

SPACER SUPPORT



- ◆ MATERIAL: PBT (UL)
- ◆ FLAME CLASS: 94V-0
- ◆ COLOR: NATURAL
- ◆ UNIT: mm

P.C.B Ø2.5
THICKNESS 1.6

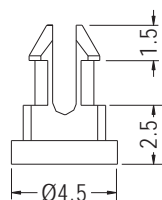

PART NO	PACKAGE
MSM-2.5	1000

