

## SPACER SUPPORT

- ◆ MATERIAL:PC (UL)
- ◆ FLAME CLASS:94V-2/94V-0
- ◆ COLOR:NATURAL/WHITE
- ◆ UNIT:mm

- ◆ MATERIAL:NYLON 66 (UL)



P.C.B Ø4.0

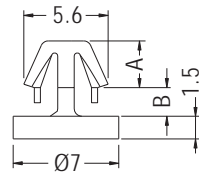

PART NO	A	B	PACKAGE
MCE-1.9	3.0	2.05	1000

P.C.B Ø4.0

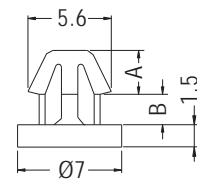

PART NO	A	B	PACKAGE
MCEA-1.9	2.8	2.2	1000

## SPACER SUPPORT

- ◆ MATERIAL:NYLON 66 (UL)
- ◆ FLAME CLASS:94V-2/94V-0
- ◆ COLOR:NATURAL/BLACK
- ◆ UNIT:mm

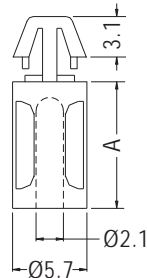

P.C.B Ø4.0  
THICKNESS 1.6

PART NO	A	PACKAGE
MCH-6	6.35	1000
MCH-10	9.7	
MCH-12	12.7	

## SPACER SUPPORT

- ◆ MATERIAL:NYLON 66 (UL)
- ◆ FLAME CLASS:94V-2/94V-0
- ◆ COLOR:NATURAL/BLACK
- ◆ UNIT:mm

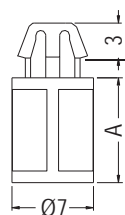

P.C.B Ø4.8  
THICKNESS 1.6

PART NO	A	PACKAGE
MCL-9	9.0	2000
MCL-16	16.0	

## SPACER SUPPORT

- ◆ MATERIAL:NYLON 66 (UL)
- ◆ FLAME CLASS:94V-2/94V-0
- ◆ COLOR:NATURAL/BLACK
- ◆ UNIT:mm

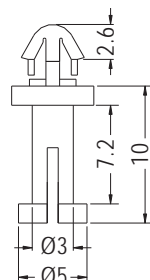

HOLE Ø3.5  
THICKNESS 1.6

PART NO	PACKAGE
MCN-10	1000