

# SPACER SUPPORT

**NEW**



- ◆ MATERIAL: NYLON 66 (UL)
- ◆ FLAME CLASS: 94V-2/94V-0
- ◆ COLOR: NATURAL/BLACK
- ◆ UNIT: mm

P.C.B Ø3.4  
THICKNESS 1.2

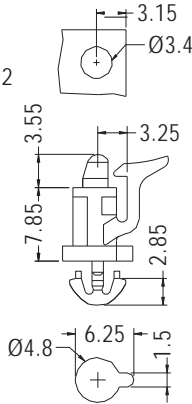
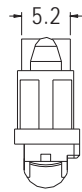

MOUNTING HOLE  
THICKNESS 1.6

PART NO	PACKAGE
ULCBA-7.8	1000

1

# SPACER SUPPORT

- ◆ MATERIAL: NYLON 66 (UL)
- ◆ FLAME CLASS: 94V-2/94V-0
- ◆ COLOR: NATURAL/WHITE/BLACK
- ◆ UNIT: mm

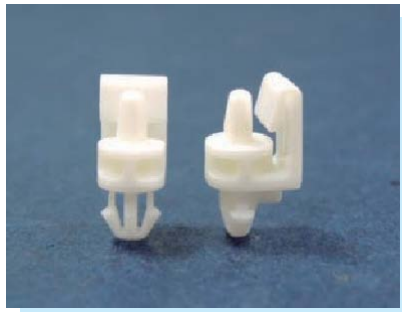

P.C.B Ø2.6  
THICKNESS 0.8-1.0

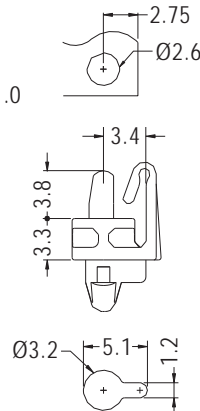
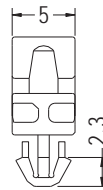

MOUNTING HOLE  
THICKNESS 1.4-1.6

PART NO	PACKAGE
LCUE-3.3	1000

# SPACER SUPPORT

- ◆ MATERIAL: NYLON 66 (UL)
- ◆ FLAME CLASS: 94V-2/94V-0
- ◆ COLOR: NATURAL/BLACK
- ◆ UNIT: mm



P.C.B Ø4.0  
THICKNESS 1.6

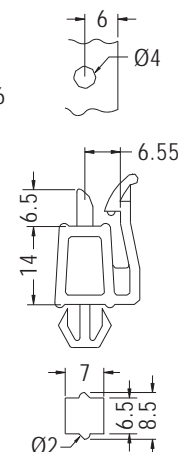
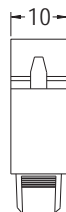

MOUNTING HOLE  
THICKNESS 0.8-2.4

PART NO	PACKAGE
KES-15	500

