

SPACER SUPPORT

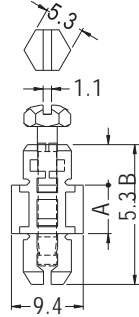

- ◆ CLIP MATERIAL:PC (UL)/94V-2
- ◆ PIN MATERIAL:NYLON 66 (UL)/94V-2
- ◆ COLOR:BLACK
- ◆ UNIT:mm



CHASSIS Ø6.4-Ø6.5
THICKNESS 0.8-1.6

| PART NO | A | B | PACKAGE |
|-----------|------|-------|---------|
| SCMB-6.3 | 6.35 | 18.3 | 1000 |
| SCMB-9.5 | 9.5 | 21.45 | |
| SCMB-12.7 | 12.7 | 24.65 | |
| SCMB-15.9 | 15.9 | 27.85 | |
| SCMB-19.1 | 19.1 | 31.05 | |

SPACER



- ◆ MATERIAL:PC (UL)
- ◆ FLAME CLASS:94V-2
- ◆ COLOR:NATURAL/BLACK
- ◆ UNIT:mm

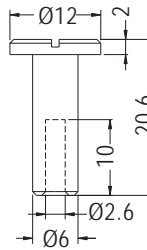

| PART NO | PACKAGE |
|---------|---------|
| SMHC-1 | 1000 |

SUPPORT



- ◆ MATERIAL:NYLON 66 (UL)/94V-0
- ◆ PIN MATERIAL:BRASS
- ◆ COLOR:NATURAL
- ◆ UNIT:mm

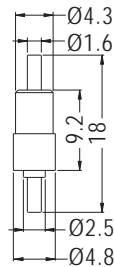

| PART NO | PACKAGE |
|----------|---------|
| ROFF-10F | 1000 |

SPACER SUPPORT



- ◆ MATERIAL:NYLON 66 (UL)/PC(UL)
- ◆ FLAME CLASS:94V-2/94V-0
- ◆ COLOR:NATURAL/BLACK/TRANSPARENT
- ◆ UNIT:mm

P.C.B Ø4.0
THICKNESS 1.6-1.9

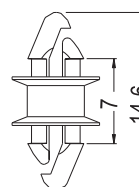

P.C.B Ø4.0
THICKNESS 1.6-1.9

| PART NO | PACKAGE |
|---------|---------|
| MSPR-3 | 1000 |

