

# LIGHT PIPE MASK

- ◆ MATERIAL: NYLON 66 (UL)
- ◆ FLAME CLASS: 94V-2/94V-0
- ◆ COLOR: BLACK
- ◆ UNIT: mm

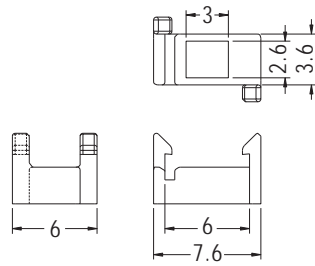
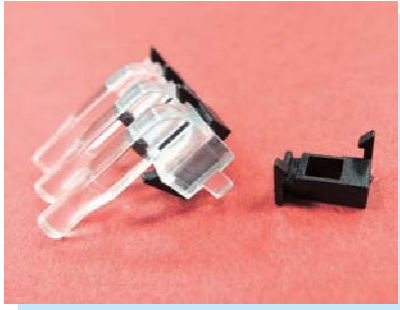

PART NO	PACKAGE
LPH-4	2000

# LIGHT PIPE

- ◆ MATERIAL: PMMA
- ◆ COLOR: TRANSPARENT
- ◆ UNIT: mm

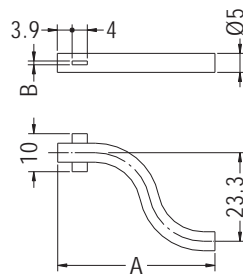

PART NO	A	B	PACKAGE
LPG-1	41.5	1.3	250
LPG-2	76.5	1.2	100

- ◆ MATERIAL: PC (UL)
- ◆ FLAME CLASS: 94V-0
- ◆ COLOR: TRANSPARENT
- ◆ UNIT: mm

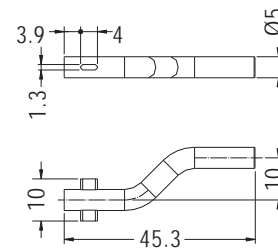

PART NO	PACKAGE
LPG-3	250

# LIGHT PIPE

- ◆ MATERIAL: PC (UL)
- ◆ FLAME CLASS: 94V-0
- ◆ COLOR: TRANSPARENT
- ◆ UNIT: mm

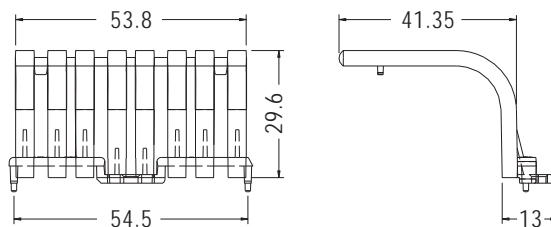

PART NO	PACKAGE
LEM-166	500

