

WIRE MOUNT

NEW

- ◆ MATERIAL: NYLON 66 (UL)
- ◆ FLAME CLASS: 94V-2/94V-0
- ◆ COLOR: NATURAL/WHITE/BLACK
- ◆ UNIT: mm

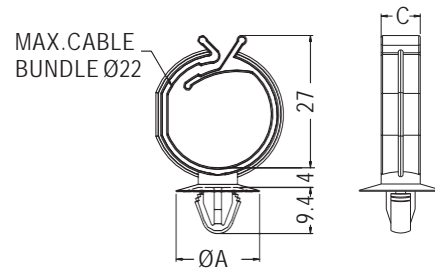
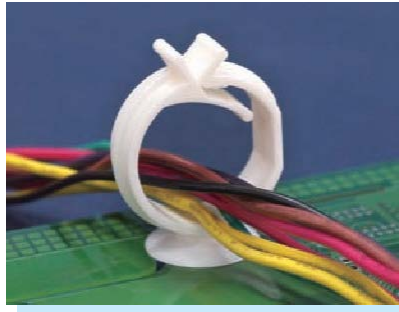

MOUNTING HOLE: ØG
THICKNESS: T

PART NO	A	C	G	T	PACKAGE
THW-2	17.0	8.0	6.5~7.0	0.6~2.0	500

WIRE MOUNT

- ◆ MATERIAL: NYLON 66 (UL)
- ◆ FLAME CLASS: 94V-2/94V-0
- ◆ COLOR: NATURAL/BLACK
- ◆ UNIT: mm

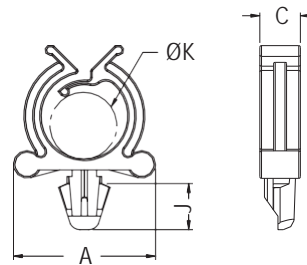
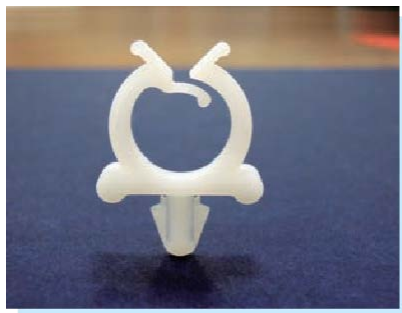

MOUNTING HOLE: ØG
THICKNESS: T

PART NO	A	C	G	J	K	T	PACKAGE
THW-1	26.2	7.5	6.35	8.7	12.3	0.8~1.6	500

WIRE MOUNT

- ◆ MATERIAL: NYLON 66 (UL)
- ◆ FLAME CLASS: 94V-2/94V-0
- ◆ COLOR: NATURAL/WHITE/BLACK
- ◆ UNIT: mm

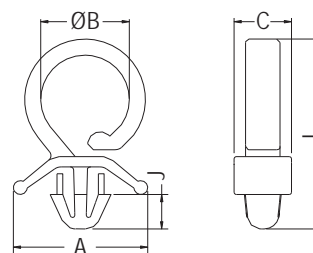
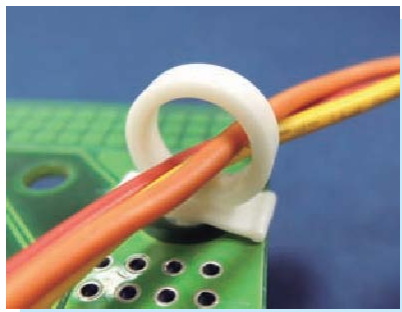

MOUNTING HOLE: ØG
THICKNESS: T

PART NO	A	B	C	G	J	L	T	PACKAGE
SLCB-8	11.7	7.7	5.0	4.0	3.0	16.5	0.6~2.0	1000

