

CABLE TIE MOUNT

- ◆ MATERIAL: NYLON 66 (UL)
- ◆ FLAME CLASS: 94V-2/94V-0
- ◆ COLOR: NATURAL/BLACK
- ◆ UNIT: mm

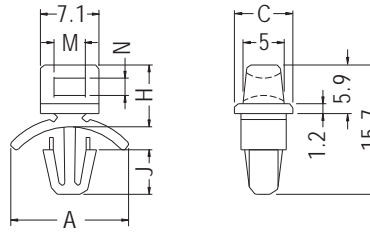

CHASSIS: ØG
THICKNESS: T

PART NO	A	C	G	H	J	M	N	T	PACKAGE
CCME-1	14.3	7.1	4.8	7.5	5.4	3.8	2.1	0.8~2.0	1000

CABLE TIE MOUNT

- ◆ MATERIAL: NYLON 66 (UL)
- ◆ FLAME CLASS: 94V-2/94V-0
- ◆ COLOR: NATURAL/BLACK
- ◆ UNIT: mm

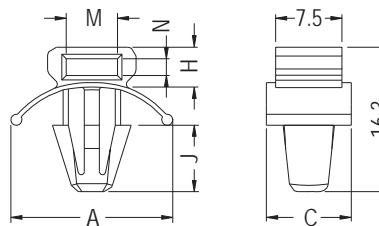
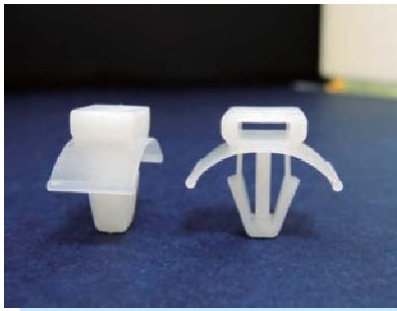

HOLE: ØG
THICKNESS: T

PART NO	A	C	G	H	J	M	N	T	PACKAGE
CCMW-3	18.3	9.6	6.2~6.35	4.5	7.5	5.8	1.9	0.8~3.6	1000

CABLE TIE MOUNT

- ◆ MATERIAL: NYLON 66 (UL)
- ◆ FLAME CLASS: 94V-0/94V-2
- ◆ COLOR: NATURAL/BLACK
- ◆ UNIT: mm

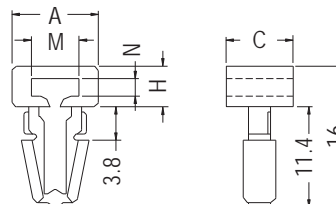

PANEL HOLE DIA: ØG
PANEL THICKNESS: T MAX.

PART NO	A	C	G	H	M	N	T	PACKAGE
CCMV-1	9.8	7.6	6.4	4.6	5.4	2.0	3.17	1000