

WIRE MOUNT

- ◆ MATERIAL: NYLON 66 (UL)
- ◆ FLAME CLASS: 94V-2/94V-0
- ◆ COLOR: NATURAL/BLACK
- ◆ UNIT: mm

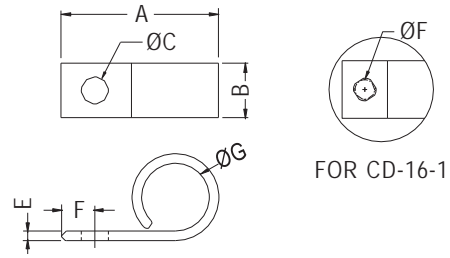
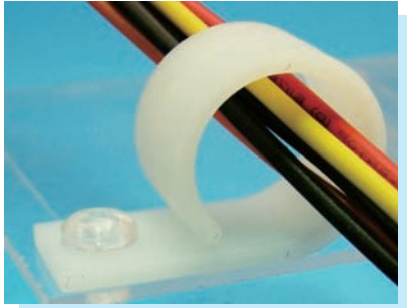

PART NO	A	B	C	E	F	G	PACKAGE
CD-12.7	29.5	10.2	5.08	1.8	6.35	12.7	500
CD-12.7-3.2	29.5	10.2	3.2	1.8	6.35	12.7	
CD-16	30.0	12.7	5.0	2.0	5.0	16.0	
CD-16-1	30.0	12.7	5.0	2.0	5.0	16.0	
CD-19	32.54	12.7	5.18	2.03	4.82	19.05	
CD-26	39.85	12.6	5.15	2.2	5.18	26.0	250
CD-40	53.5	12.6	5.0	2.5	4.8	36.9	100

WIRE MOUNT

- ◆ MATERIAL: NYLON 66 (UL)
- ◆ FLAME CLASS: 94V-2/94V-0
- ◆ COLOR: NATURAL/BLACK
- ◆ UNIT: mm

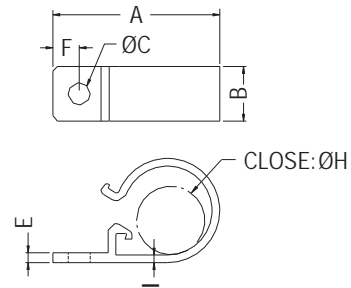

PART NO	A	B	C	E	F	H	I	PACKAGE
CCA-1	30.4	9.95	4.0	1.8	4.8	12.5	1.4	1000
CCA-2	30.4	9.95	4.0	1.4	4.8	12.5	1.3	

WIRE MOUNT

- ◆ MATERIAL: NYLON 66 (UL)
- ◆ FLAME CLASS: 94V-2/94V-0
- ◆ COLOR: NATURAL/BLACK
- ◆ UNIT: mm

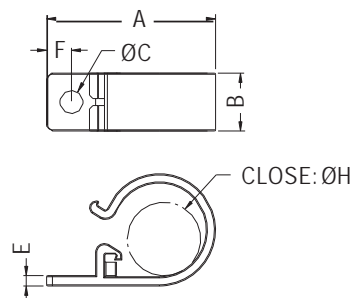

PART NO	A	B	C	E	F	H	PACKAGE
CCB-1	29.2	10.0	4.0	1.8	4.3	12.7	500
CCB-2	21.0	10.0	4.0	1.2	6.0	5.5	
CCB-2S	21.0	10.0	3.1	1.2	6.0	5.5	
CCB-3	39.6	12.7	4.0	2.0	4.2	17.8	200
CCB-4	50.0	12.7	4.0	2.2	4.3	25.0	

