

WIRE MOUNT

- ◆ MATERIAL: NYLON 66 (UL)
- ◆ FLAME CLASS: 94V-2/94V-0
- ◆ COLOR: NATURAL/BLACK
- ◆ UNIT: mm

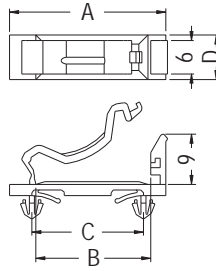

CHASSIS: ØG
THICKNESS: T

PART NO	A	B	C	D	G	T	PACKAGE
WDT-20	28.0	20.6	20.0	8.0	3.0	0.8~1.2	500

FLAT CABLE CLAMP

- ◆ MATERIAL: NYLON 66 (UL)
- ◆ FLAME CLASS: 94V-2/94V-0
- ◆ COLOR: NATURAL/BLACK
- ◆ UNIT: mm

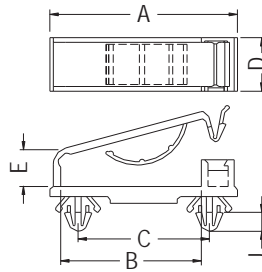

19.6
ØG
MOUNTING HOLES
THICKNESS: T

PART NO	A	B	C	D	E	G	J	T	PACKAGE
FDT-2	28.0	21.0	19.6	8.0	5.5	3.0	2.8	0.8~1.2	1000
FDT-2-1.6	28.0	21.0	19.6	8.0	5.5	3.0	2.8	0.8~1.6	

FLAT CABLE CLAMP

- ◆ MATERIAL: NYLON 66 (UL)
- ◆ FLAME CLASS: 94V-2/94V-0
- ◆ COLOR: NATURAL/BLACK
- ◆ UNIT: mm

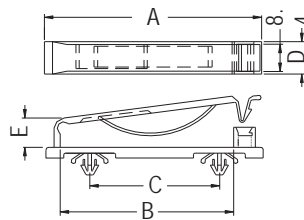
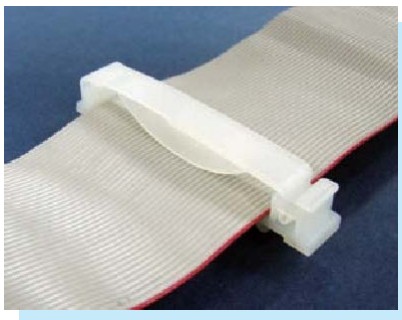

40
ØG
MOUNTING HOLES
THICKNESS: T

PART NO	A	B	C	D	E	G	T	PACKAGE
FDT-4	67.0	53.5	40.0	10.0	9.0	4.0	0.8~2.0	100

