

WIRE MOUNT

- ◆ MATERIAL: NYLON 66 (UL)
- ◆ FLAME CLASS: 94V-2/94V-0
- ◆ COLOR: NATURAL/BLACK
- ◆ UNIT: mm

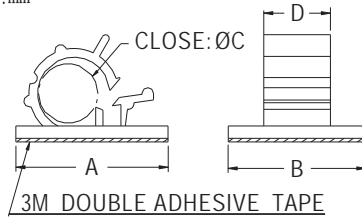

PART NO	A	B	C	D	PACKAGE
FWS-1	21.0	19.0	8.2	9.2	500
FWS-2	25.0	20.0	9.0	12.0	
FWS-3	25.0	19.7	10.6	12.1	
FWS-4	29.0	20.0	12.6	14.0	250
FWS-7	29.6	19.5	12.8	14.8	
FWS-8	21.6	17.0	10.4	12.0	
FWS-10	19.0	19.0	6.8	8.8	500

WIRE MOUNT

- ◆ MATERIAL: NYLON 66 (UL)
- ◆ FLAME CLASS: 94V-2/94V-0
- ◆ COLOR: NATURAL/BLACK
- ◆ UNIT: mm

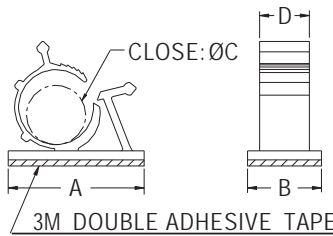

PART NO	A	B	C	D	PACKAGE	UL
AWC-1	24.8	18.8	7.9~10.3	10.2		UL
AWC-2	25.4	15.0	11.0~13.3	10.0	250	UL
AWC-2A	30.2	15.0	11.9~14.3	10.0		
AWC-3	34.4	18.8	14.7~19.1	12.7		UL
AWC-4	36.0	19.0	18.0~22.0	12.7	100	UL
AWC-5	39.8	19.8	22.0~26.5	13.0		UL

WIRE MOUNT

- ◆ MATERIAL: NYLON 66 (UL)
- ◆ FLAME CLASS: 94V-2/94V-0
- ◆ COLOR: NATURAL/BLACK
- ◆ UNIT: mm

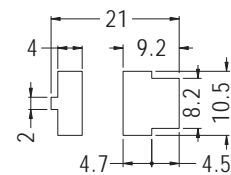
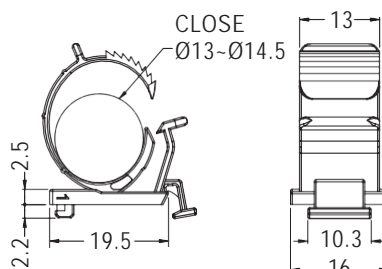

MOUNTING HOLES

PART NO	PACKAGE
AWE-1	500