

WIRE MOUNT

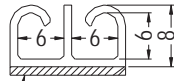

- ◆ MATERIAL: NYLON 66 (UL)
- ◆ FLAME CLASS: 94V-2/94V-0
- ◆ COLOR: NATURAL/BLACK
- ◆ UNIT: mm

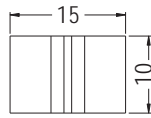

3M DOUBLE ADHESIVE TAPE

PART NO	PACKAGE
WLLT-1	1000

WIRE MOUNT



- ◆ MATERIAL: NYLON 66 (UL)
- ◆ FLAME CLASS: 94V-2/94V-0
- ◆ COLOR: NATURAL/BLACK
- ◆ UNIT: mm

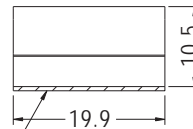
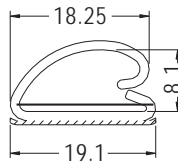

3M DOUBLE ADHESIVE TAPE

PART NO	PACKAGE
WUD-1	1000

WIRE MOUNT

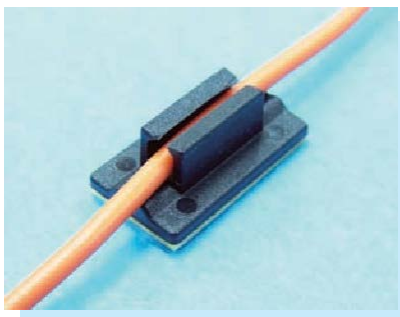

- ◆ MATERIAL: NYLON 66 (UL)
- ◆ FLAME CLASS: 94V-2/94V-0
- ◆ COLOR: NATURAL/BLACK
- ◆ UNIT: mm

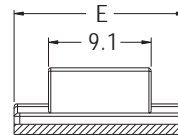
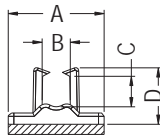

3M DOUBLE ADHESIVE TAPE

PART NO	A	B	C	D	E	PACKAGE
WTC-2	8.5	2.5	2.7	5.0	15.2	500
WTC-3	9.0	3.6	4.0	6.5	16.0	

WIRE MOUNT

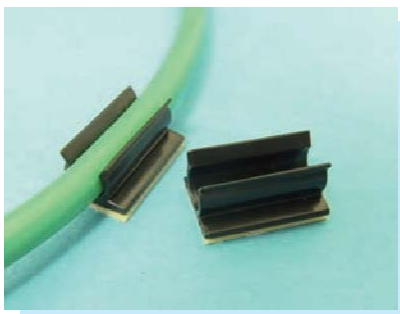

- ◆ MATERIAL: ABS
- ◆ COLOR: BLACK
- ◆ UNIT: mm

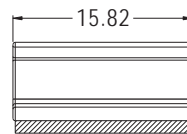
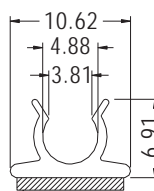

3M DOUBLE ADHESIVE TAPE

PART NO	PACKAGE
THVC-1	500