

## WIRE MOUNT

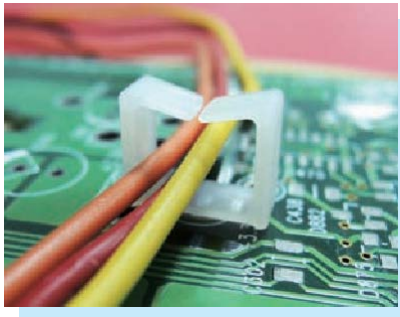

- ◆ MATERIAL: NYLON 66 (UL)
- ◆ FLAME CLASS: 94V-2/94V-0
- ◆ COLOR: NATURAL/BLACK
- ◆ UNIT: mm

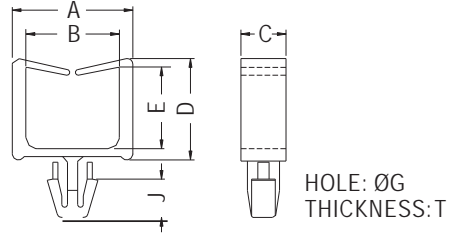

PART NO	A	B	C	D	E	G	J	T	PACKAGE
MWS-38	10.7	8.3	4.0	9.0	7.2	3.0	3.4	1.6	1000

## WIRE MOUNT

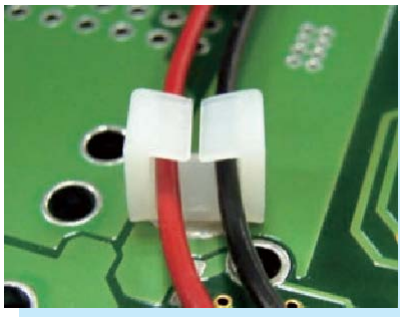

- ◆ MATERIAL: NYLON 66 (UL)
- ◆ FLAME CLASS: 94V-2/94V-0
- ◆ COLOR: NATURAL/BLACK
- ◆ UNIT: mm

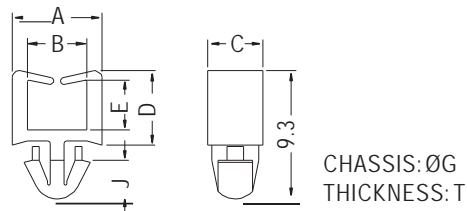

PART NO	A	B	C	D	E	G	J	T	PACKAGE
MWS-13	6.5	4.3	4.0	5.4	3.6	3.5	2.8	1.0	1000
MWS-13L	7.8	5.6	4.0	5.4	3.6	3.5	2.8	1.5	
MWS-14	6.5	4.3	4.0	5.4	3.6	3.5	2.8	4.0	

## WIRE MOUNT

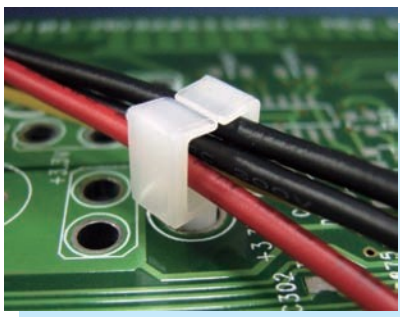

- ◆ MATERIAL: NYLON 66 (UL)
- ◆ FLAME CLASS: 94V-2/94V-0
- ◆ COLOR: NATURAL/BLACK
- ◆ UNIT: mm

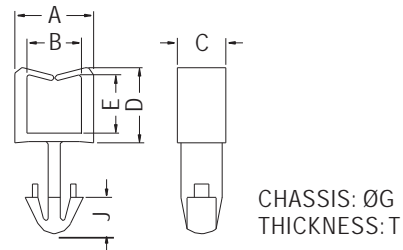

PART NO	A	B	C	D	E	G	J	T	PACKAGE
MWS-20	6.5	4.5	4.0	6.2	4.8	3.5	3.0	4.0	1000
MWS-25	6.5	4.3	4.0	6.2	4.8	3.5	3.0	2.5	

## WIRE MOUNT

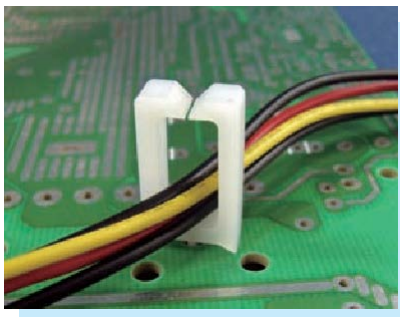

- ◆ MATERIAL: NYLON 66 (UL)
- ◆ FLAME CLASS: 94V-2/94V-0
- ◆ COLOR: NATURAL/BLACK
- ◆ UNIT: mm

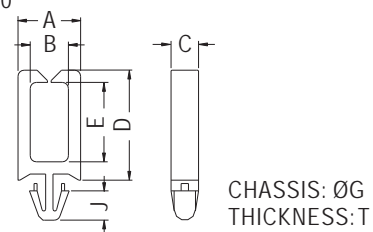

PART NO	A	B	C	D	E	G	J	T	PACKAGE
CHY-1	10.25	6.25	4.5	18.0	13.0	4.8	4.8	1.8	1000
CHY-1S	10.25	6.25	4.5	18.0	13.0	3.0	2.5	1.6	