

WIRE MOUNT

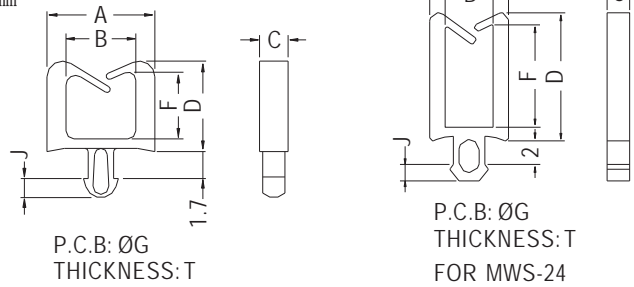

- ◆ MATERIAL: NYLON 66 (UL)
- ◆ FLAME CLASS: 94V-2/94V-0
- ◆ COLOR: NATURAL/BLACK
- ◆ UNIT: mm



PART NO	A	B	C	D	F	G	J	T	PACKAGE
MWS-16	6.8	4.4	1.8	5.7	4.2	1.75	1.2	1.6	2000
MWS-24	6.98	4.25	2.0	11.3	9.5	2.8	1.46	2.0	

WIRE MOUNT

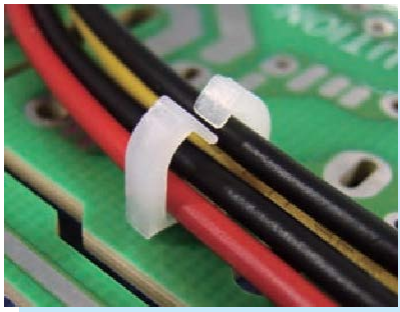

- ◆ MATERIAL: NYLON 66 (UL)
- ◆ FLAME CLASS: 94V-2/94V-0
- ◆ COLOR: NATURAL/BLACK
- ◆ UNIT: mm

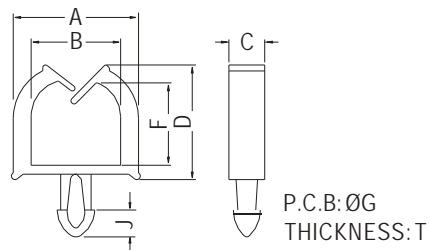

PART NO	A	B	C	D	F	G	J	T	PACKAGE
MWS-17	7.2	5.0	2.0	6.4	4.6	1.75	1.5	1.6	2000
MWS-44	8.5	6.5	2.0	7.0	5.2	1.75	1.5	1.6	

WIRE MOUNT

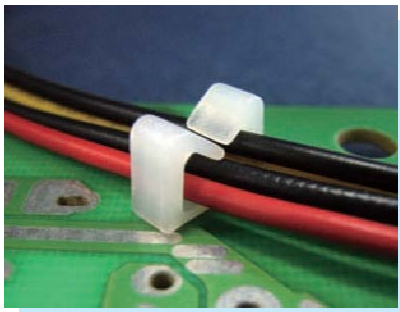

- ◆ MATERIAL: NYLON 66 (UL)
- ◆ FLAME CLASS: 94V-2/94V-0
- ◆ COLOR: NATURAL/BLACK
- ◆ UNIT: mm

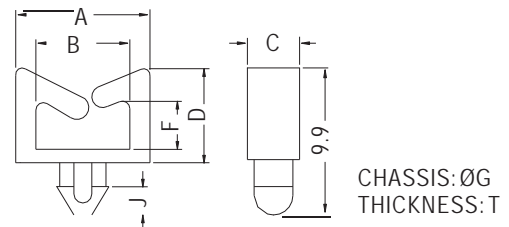

PART NO	A	B	C	D	F	G	J	T	PACKAGE
MWS-1	9.0	6.3	3.5	6.4	3.6	3.0	3.6	1.2~1.6	2000

WIRE MOUNT



- ◆ MATERIAL: NYLON 66 (UL)
- ◆ FLAME CLASS: 94V-2/94V-0
- ◆ COLOR: NATURAL/BLACK
- ◆ UNIT: mm

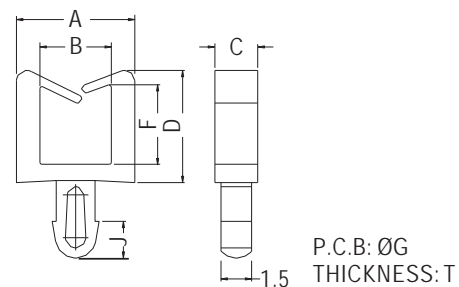

PART NO	A	B	C	D	F	G	J	T	PACKAGE
MWS-8	5.8	3.5	2.1	5.5	3.9	2.0	1.8	1.6~1.8	2000