

WIRE SADDLE SIDE ENTRY

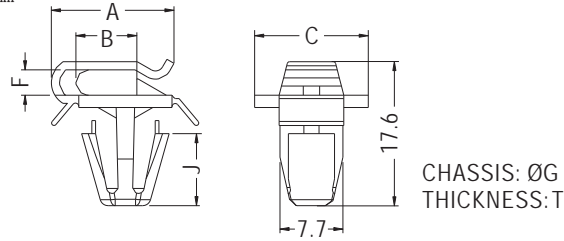

- ◆ MATERIAL: NYLON 66 (UL)
- ◆ FLAME CLASS: 94V-2/94V-0
- ◆ COLOR: NATURAL/BLACK
- ◆ UNIT: mm



PART NO	A	B	C	F	G	J	T	PACKAGE
FCCA-1	15.0	7.45	13.9	3.1	8.0	8.8	1.0~2.8	1000

WIRE MOUNT

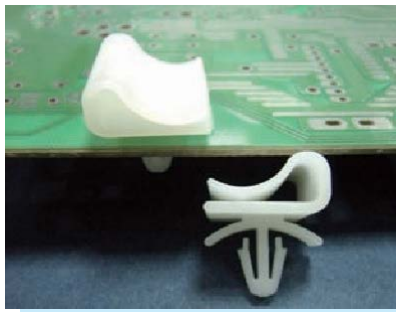

- ◆ MATERIAL: NYLON 66 (UL)
- ◆ FLAME CLASS: 94V-2/94V-0
- ◆ COLOR: NATURAL/BLACK
- ◆ UNIT: mm

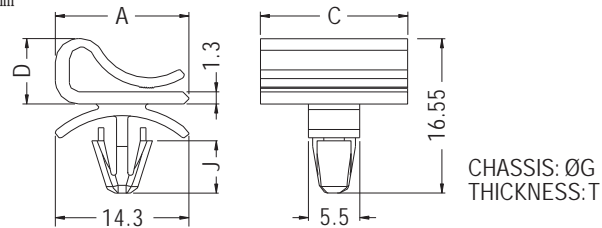

PART NO	A	C	D	G	J	T	PACKAGE
FCCB-1	14.3	15.8	7.0	4.8	5.6	0.6~2.0	1000

WIRE MOUNT

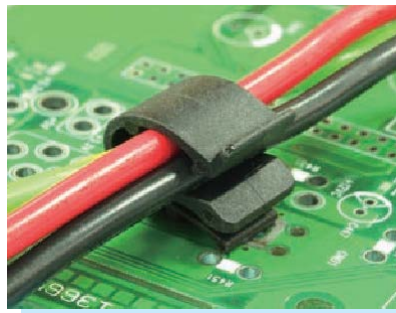

- ◆ MATERIAL: NYLON 66 (UL)
- ◆ FLAME CLASS: 94V-2/94V-0
- ◆ COLOR: NATURAL/BLACK
- ◆ UNIT: mm

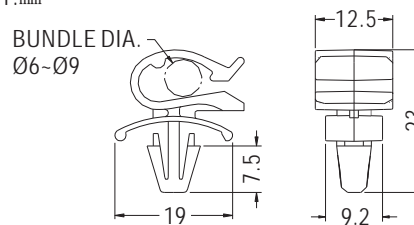

MOUNTING HOLE Ø6.3-Ø6.5
THICKNESS 1.0-3.0

PART NO	PACKAGE
FCCD-1	1000

FLAT CABLE CLAMP

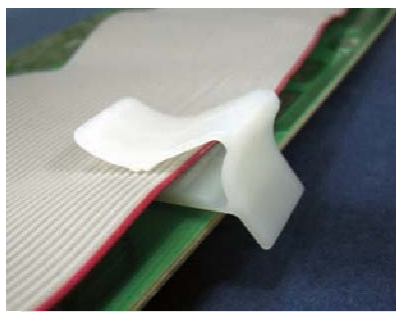

- ◆ MATERIAL: NYLON 66 (UL)
- ◆ FLAME CLASS: 94V-2/94V-0
- ◆ COLOR: NATURAL/BLACK
- ◆ UNIT: mm

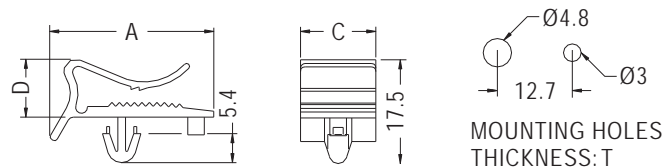

PART NO	A	C	D	T	PACKAGE
FCCT-12	28.0	12.7	9.8	0.8~2.5	500