

FLAT CABLE CLAMP

- ◆ MATERIAL: NYLON 66 (UL)
- ◆ FLAME CLASS: 94V-2
- ◆ COLOR: NATURAL
- ◆ UNIT: mm

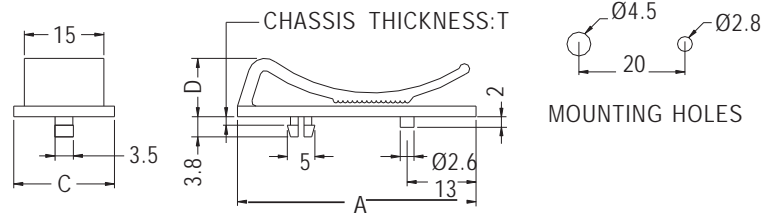

PART NO	A	C	D	T	PACKAGE
FCG-15	45.0	19.0	11.0	1.2	1000

WIRE SADDLE SIDE ENTRY

- ◆ MATERIAL: NYLON 66 (UL)
- ◆ FLAME CLASS: 94V-2/94V-0
- ◆ COLOR: NATURAL/BLACK
- ◆ UNIT: mm

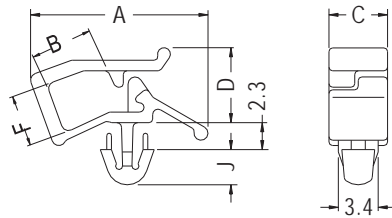
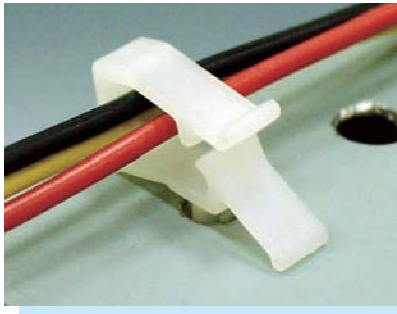

CHASSIS: ØG
THICKNESS: T

PART NO	A	B	C	D	F	G	J	T	PACKAGE
WPEM-1	20.3	7.2	5.0	8.5	6.2	3.5	3.0	0.5~1.6	1000
WPEM-1S	15.2	5.3	5.0	6.4	4.3				
WPEM-2	13.5	4.1	5.0	5.0	2.6				

WIRE SADDLE SIDE ENTRY

- ◆ MATERIAL: NYLON 66 (UL)
- ◆ FLAME CLASS: 94V-2/94V-0
- ◆ COLOR: NATURAL/BLACK/GRAY
- ◆ UNIT: mm

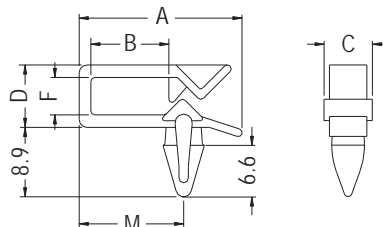
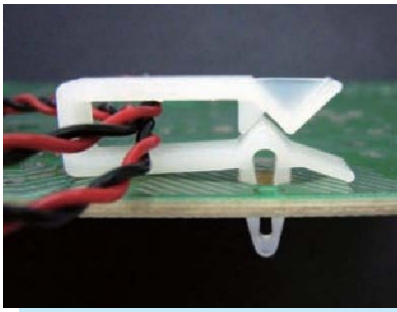

CHASSIS: ØG
THICKNESS: T

PART NO	A	B	C	D	F	G	M	T	PACKAGE
WPEG-1	20.9	10.0	6.2	8.0	4.8	4.8	13.4	2.0	1000
WPEG-2	24.2	13.2					16.8		
WPEG-3	17.5	6.6					10.8		

