

# HOLE PLUGS

- ◆ MATERIAL: NYLON 66 (UL)
- ◆ FLAME CLASS: 94V-2/94V-0
- ◆ COLOR: NATURAL/BLACK/GRAY
- ◆ UNIT: mm

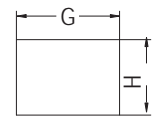
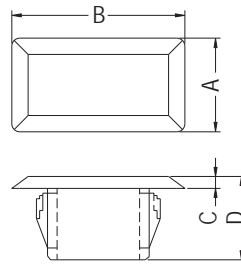

MOUNTING HOLE THICKNESS: F

PART NO	A	B	C	D	F	G	H	PACKAGE
MSQ-1	11.8	21.8	1.5	10.5	0.8-3.5	13.0	9.5	500
MSQ-2	11.9	35.0	1.5	10.5	0.8-3.5	26.0	9.5	
MSQ-4	12.0	16.0	1.5	10.5	1.4-3.5	13.0	9.5	
MSQ-5	15.0	15.0	2.0	11.0	0.75-3.8	13.5	13.5	
MSQ-6	14.0	24.3	1.5	10.5	0.8-3.5	16.0	11.5	
MSQ-7	8.0	18.0	1.5	10.5	0.8-3.5	16.5	6.5	
MSQ-9	19.0	19.3	1.5	10.5	0.8-3.5	17.3	17.0	
MSQ-10	15.7	39.0	1.5	10.5	1.4-3.5	35.5	12.2	

# RUBBER PLUGS

- ◆ MATERIAL: RUBBER
- ◆ COLOR: BLACK
- ◆ UNIT: mm

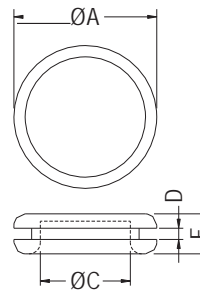

MOUNTING HOLE: ØB FOR DGB-19

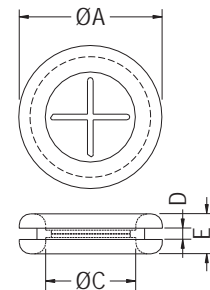

MOUNTING HOLE: ØB FOR DGB-19A

PART NO	A	B	C	D	E	PACKAGE
DGB-19	25.4	19.0	16.0	2.0	7.1	500
DGB-19A	25.4	19.0	16.0	2.0	7.1	

# RUBBER PLUGS

- ◆ MATERIAL: RUBBER
- ◆ COLOR: BLACK
- ◆ UNIT: mm

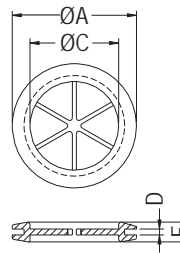

MOUNTING HOLE: ØB FOR DGB-25

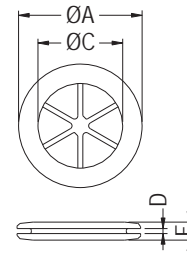

MOUNTING HOLE: ØB FOR DGB-26

PART NO	A	B	C	D	E	PACKAGE
DGB-25	31.4	25.4	22.4	1.5	5.0	500
DGB-26	37.2	28.5	25.5	1.5	5.42	

