

# HOLE PLUGS SCREW

- ◆ MATERIAL: NYLON 66 (UL)
- ◆ FLAME CLASS: 94V-2/94V-0
- ◆ COLOR: BLACK
- ◆ UNIT: mm

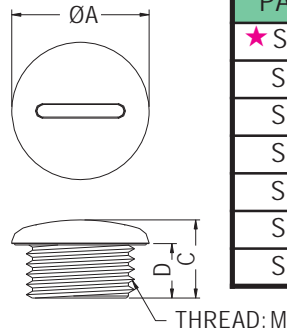

PART NO	A	C	D	M	PACKAGE
★ SPMA-10	15.0	12.0	8.5	M10X1.5	500
SPMA-12	15.0	10.0	6.0	M12X1.5	
SPMA-16	20.2	11.5	8.0	M16X1.5	
SPMA-20	24.0	12.5	7.5	M20X1.5	
SPMA-25	30.0	15.0	11.0	M25X1.5	
SPMA-32	37.0	15.7	10.8	M32X1.5	
SPMA-40	46.0	17.5	12.0	M40X1.5	

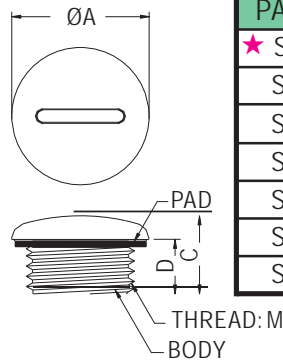

PART NO	A	C	D	M	PACKAGE
★ SPMB-10	15.0	12.0	8.5	M10X1.5	500
SPMB-12	15.0	10.0	6.0	M12X1.5	
SPMB-16	20.2	11.5	8.0	M16X1.5	
SPMB-20	24.0	12.5	7.5	M20X1.5	
SPMB-25	30.0	15.0	11.0	M25X1.5	
SPMB-32	37.0	15.7	10.8	M32X1.5	
SPMB-40	46.0	17.5	12.0	M40X1.5	

# HOLE PLUGS SCREW

- ◆ MATERIAL: NYLON 66 (UL)
- ◆ FLAME CLASS: 94V-2/94V-0
- ◆ COLOR: BLACK
- ◆ UNIT: mm

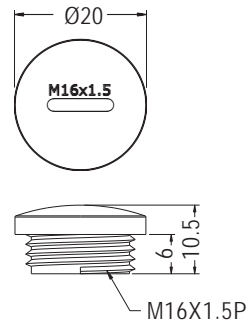

PART NO	PACKAGE
SPM-16	500

# SCREW

- ◆ MATERIAL: NYLON 66 (UL)
- ◆ FLAME CLASS: 94V-2/94V-0
- ◆ COLOR: NATURAL/BLACK
- ◆ UNIT: mm

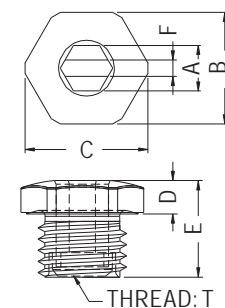

FOR MOTA-20

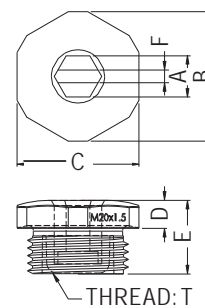

PART NO	A	B	C	D	E	F	T	PACKAGE
MOTA-12	6.1	15.0	16.5	4.5	13.0	2.2	M12X1.5P	500
MOTA-16	8.1	19.0	20.5	4.5	13.0	2.2	M16X1.5P	
MOTA-20	8.1	25.5	24.0	5.5	14.5	2.5	M20X1.5P	

