

SNAP RIVET

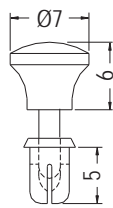

- ◆ MATERIAL: NYLON 66 (UL)
- ◆ FLAME CLASS: 94V-2/94V-0
- ◆ COLOR: BLACK
- ◆ UNIT: mm



CHASSIS Ø3.5
THICKNESS 2.5~3.5

PART NO	PACKAGE
SRS3.5-5P	1000

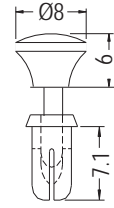

CHASSIS Ø4.1
THICKNESS 4.5~5.5

PART NO	PACKAGE
SRS4-7P	1000

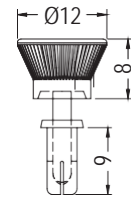

CHASSIS Ø4.1-Ø4.2
THICKNESS 6.5~7.5

PART NO	PACKAGE
SRS4-9K	1000



SNAP RIVET



- ◆ MATERIAL: NYLON 66 (UL)
- ◆ FLAME CLASS: 94V-2/94V-0
- ◆ COLOR: BLACK
- ◆ UNIT: mm

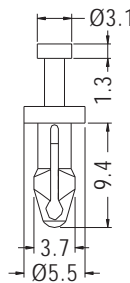

HOLE IN FAN Ø3.1~Ø3.3
THICKNESS 3.9~4.6

PART NO	PACKAGE
SRCC-12F	1000

SNAP RIVET



NEW

- ◆ MATERIAL: TPE
- ◆ PIN MATERIAL: NYLON 66 (UL)
- ◆ FLAME CLASS: 94V-2/94V-0
- ◆ COLOR: BLACK
- ◆ UNIT: mm

HOLE IN FAN Ø3.6
THICKNESS 0.8

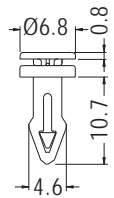

HOLE IN FAN Ø3.5
THICKNESS 5.0

PART NO	PACKAGE
SRCC-13	1000

SNAP RIVET



- ◆ MATERIAL: TPV (UL)
- ◆ PIN MATERIAL: NYLON 66 (UL)
- ◆ FLAME CLASS: 94V-0
- ◆ COLOR: BLACK
- ◆ UNIT: mm

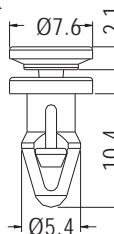

HOLE IN FAN Ø4.5
THICKNESS 3.5

PART NO	PACKAGE
SRCC-11	1000

