

SNAP RIVET

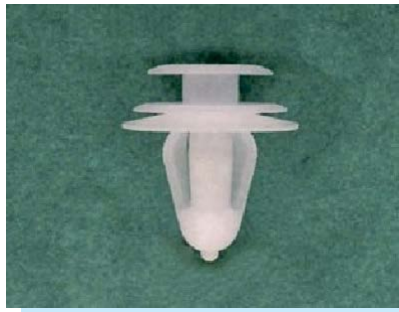

- ◆ MATERIAL: NYLON 66 (UL)
- ◆ FLAME CLASS: 94V-2/94V-0
- ◆ COLOR: NATURAL/BLACK
- ◆ UNIT: mm

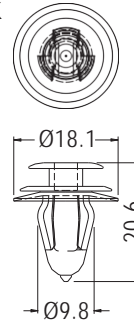

CHASSIS Ø8.0
THICKNESS 0.8~1.6

PART NO	PACKAGE
CAPR-10	500

SNAP RIVET



- ◆ MATERIAL: NYLON 66 (UL)
- ◆ FLAME CLASS: 94V-2/94V-0
- ◆ COLOR: NATURAL/BLACK
- ◆ UNIT: mm

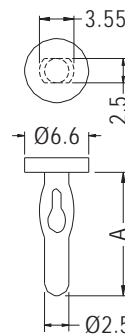

PART NO	A	PACKAGE
PIC-10	8.5	1000
PIC-14	12.7	

SNAP RIVET

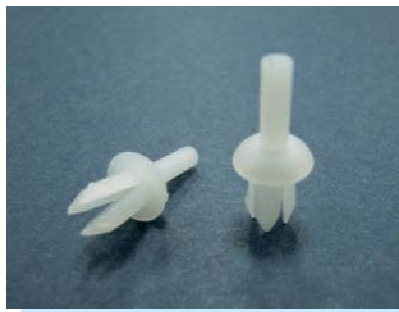

- ◆ MATERIAL: NYLON 66 (UL)
- ◆ FLAME CLASS: 94V-2/94V-0
- ◆ COLOR: NATURAL/BLACK
- ◆ UNIT: mm

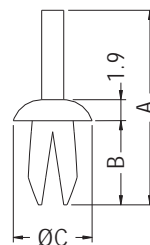

CHASSIS: ØD
THICKNESS 1.57~5.53

PART NO	A	B	C	D	PACKAGE
PSR-1	17.62	7.62	7.14	4.0	1000
PSR-2	16.1	7.4	7.14	4.8	

- ◆ MATERIAL: NYLON 66 (UL)/PP
- ◆ FLAME CLASS: 94V-2/94V-0
- ◆ COLOR: NATURAL/BLACK/GRAY
- ◆ UNIT: mm

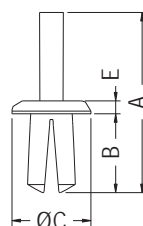

MOUNTING HOLE: ØD

PART NO	A	B	C	D	E	PACKAGE
PSR-3	26.5	11.6	11.6	6.3	1.9	1000
★ PSR-4	17.8	7.9	8.7	4.8	2.0	

