

MOUNTING BUTTON

◆ UNIT:mm

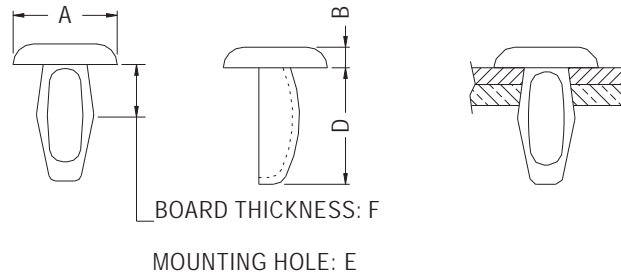
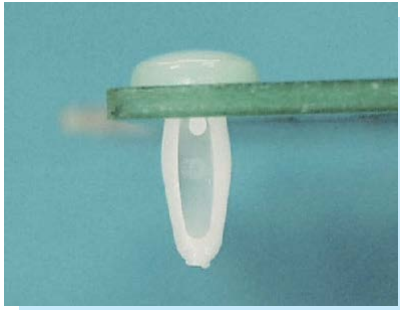

PART NO	MATERIAL	COLOR	A	B	D	E	F	PACKAGE
MB-1N	NYLON 66 UL94V-2	NATURAL	7.6	1.6	8.6	3.3-3.5	2.0-3.1	2000
MB-1	POM UL94HB	WHITE						
MB-1(B)		BLACK						
MB-2N	NYLON 66 UL94V-2	NATURAL	7.6	1.3	10.8	3.3-3.6	3.0-4.0	1000
MB-2	POM UL94HB	WHITE						
MB-2(B)		BLACK						
MB-3N	NYLON 66 UL94V-2	NATURAL	7.3	1.4	8.4	3.0-3.2	2.0-3.5	2000
MB-3N(B)		BLACK						

MOUNTING BUTTON

- ◆ MATERIAL:NYLON 66 (UL)
- ◆ FLAME CLASS:94V-2/94V-0
- ◆ COLOR:NATURAL/BLACK
- ◆ UNIT:mm

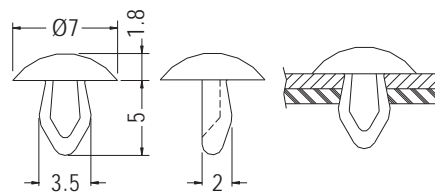

CHASSIS Ø3.15-Ø3.2
THICKNESS 1.6-1.9

PART NO	PACKAGE
MB-4	2000

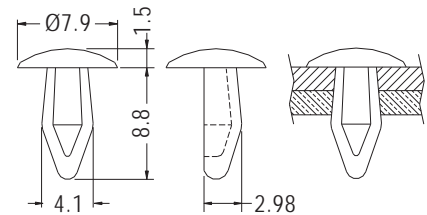

CHASSIS Ø3.5-Ø3.7
THICKNESS 3.5-4.0

PART NO	PACKAGE
MB-5	2000

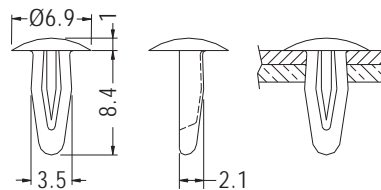

CHASSIS Ø3.1-Ø3.2
THICKNESS 2.0-2.5

PART NO	PACKAGE
MB-6	2000

- ◆ MATERIAL:NYLON 66 (UL)
- ◆ FLAME CLASS:94V-2/94V-0
- ◆ COLOR:NATURAL/BLACK/WHITE
- ◆ UNIT:mm

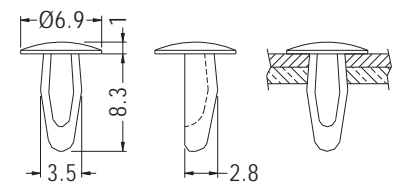

CHASSIS Ø3.1-Ø3.2
THICKNESS 2.0-2.5

PART NO	PACKAGE
MB-7	2000

