

MOUNTING BUTTON

- ◆ MATERIAL: NYLON 66 (UL)
- ◆ FLAME CLASS: 94V-2/94V-0
- ◆ COLOR: NATURAL/BLACK
- ◆ UNIT: mm

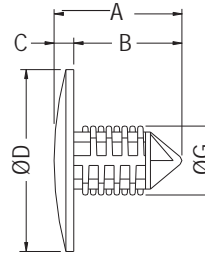
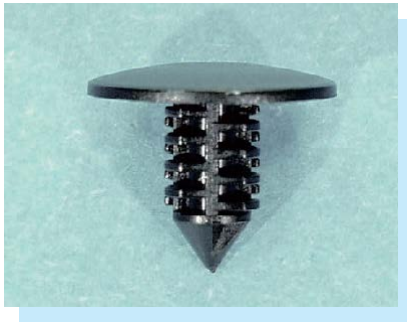

MOUNTING HOLE: ØF
THICKNESS: E

PART NO	A	B	C	D	E	F	G	PACKAGE
MBW6-11	13.0	11.0	2.0	18.5	0.8~7.4	6.35	7.4	1000
MBW7-20	23.0	20.0	3.0	25.4	2.54~20.0	7.0	7.86	

MOUNTING BUTTON

- ◆ MATERIAL: NYLON 66 (UL)
- ◆ FLAME CLASS: 94V-2/94V-0
- ◆ COLOR: NATURAL/BLACK
- ◆ UNIT: mm

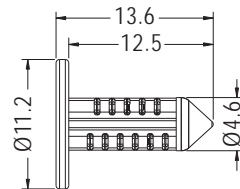

MOUNTING HOLE Ø5.0
THICKNESS 2.5~4.5

PART NO	PACKAGE
MBW-29	1000

SCREW RIVET

- ◆ MATERIAL: NYLON 66 (UL)
- ◆ FLAME CLASS: 94V-2/94V-0
- ◆ COLOR: NATURAL/BLACK
- ◆ UNIT: mm

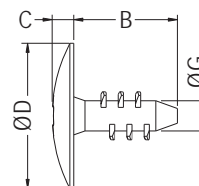

FOR M6 NUT
THICKNESS: E

PART NO	B	C	D	E	G	PACKAGE
MBWC-1	12.0	2.5	16.8	5.0	3.5	1000
MBWC-4	18.0	2.5	16.8	10.0	3.45	

