

## MOUNTING BUTTON

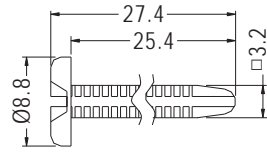

- ◆ MATERIAL: NYLON 66 (UL)
- ◆ FLAME CLASS: 94V-2/94V-0
- ◆ COLOR: NATURAL/BLACK
- ◆ UNIT: mm



MOUNTING HOLE Ø3.0

PART NO	PACKAGE
MBW-18	1000

## MOUNTING BUTTON



- ◆ MATERIAL: NYLON 66 (UL)
- ◆ FLAME CLASS: 94V-2/94V-0
- ◆ COLOR: NATURAL/BLACK
- ◆ UNIT: mm

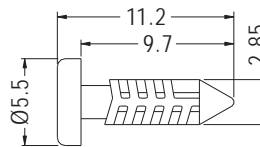

MOUNTING HOLE Ø3.0

PART NO	PACKAGE
MBW-21	1000

## SNAPRIVET



- ◆ MATERIAL: NYLON 66 (UL)
- ◆ FLAME CLASS: 94V-2/94V-0
- ◆ COLOR: NATURAL/BLACK
- ◆ UNIT: mm

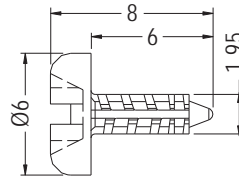

MOUNTING HOLE Ø2.2

PART NO	PACKAGE
MBW-36	2000

## SNAPRIVET



- ◆ MATERIAL: NYLON 66 (UL)
- ◆ FLAME CLASS: 94V-2/94V-0
- ◆ COLOR: NATURAL/BLACK/RED
- ◆ UNIT: mm

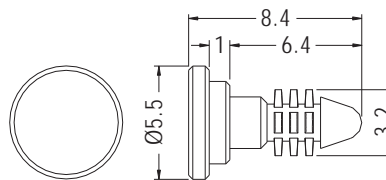

MOUNTING HOLE Ø3.0

PART NO	PACKAGE
MBW-38	2000

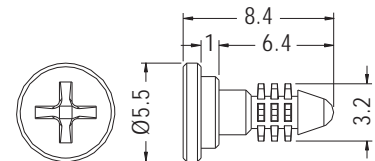

MOUNTING HOLE Ø3.0

PART NO	PACKAGE
★ MBW-40	2000