

CARD GUIDE

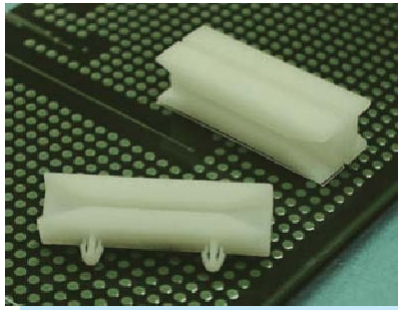

- ◆ MATERIAL: NYLON 66 (UL)
- ◆ FLAME CLASS: 94V-2/94V-0
- ◆ COLOR: NATURAL/BLACK
- ◆ UNIT: mm

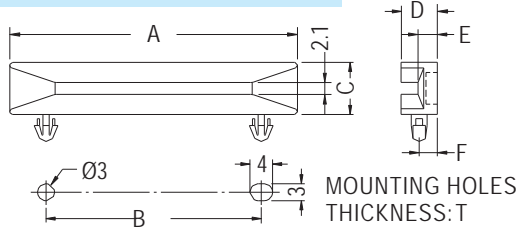

PART NO	A	B	C	D	E	F	T	PACKAGE
CGLA-4							1.6-1.7	500
CGLA-4(1)	38.4	20.0	9.2	6.4	3.4	3.2	1.0	
CGLA-4(2)							2.0	
CGLA-4S	40.0	20.0	8.0	6.0	3.0	3.0	1.6	250
CGLA-6	51.0	38.2	9.2	6.4	3.4	3.2	1.6-1.7	
CGLA-8							1.6-1.8	
CGLA-8(2)	81.0	60.0					1.8-2.1	
CGLA-8(8)			8.0	6.0	3.0	3.0	1.8	
CGLA-8(25)							2.5	
CGLA-9(1)	91.5	71.0					1.6-1.8	250
CGLA-9(2)							1.8-2.1	

CARD GUIDE



- ◆ MATERIAL: NYLON 66 (UL)
- ◆ FLAME CLASS: 94V-2/94V-0
- ◆ COLOR: NATURAL/BLACK
- ◆ UNIT: mm

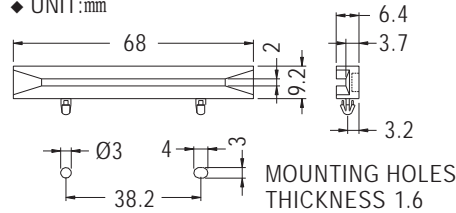

PART NO	PACKAGE
CGLA-10	200

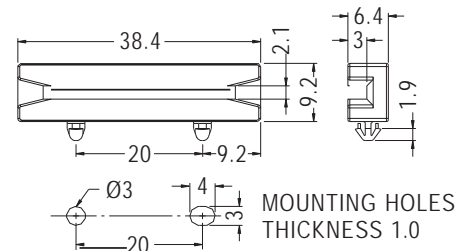

PART NO	PACKAGE
CGLA-11	500

CARD GUIDE

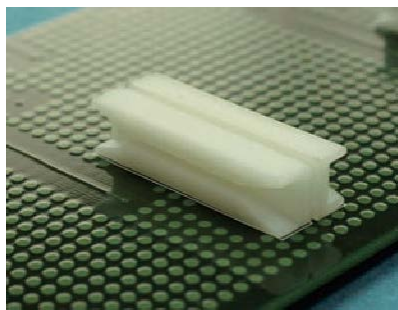

- ◆ MATERIAL: NYLON 66 (UL)
- ◆ FLAME CLASS: 94V-2/94V-0
- ◆ COLOR: NATURAL/BLACK
- ◆ UNIT: mm

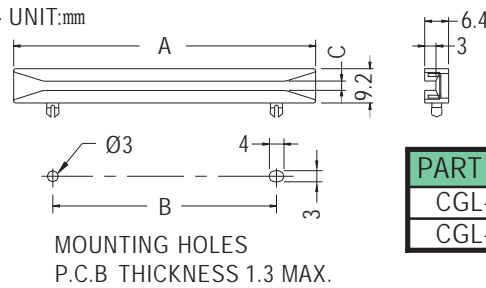

PART NO	A	B	C	PACKAGE
CGL-4	38.4	20.0	2.0	500
CGL-8	81.0	60.0	2.5	250

CARD GUIDE

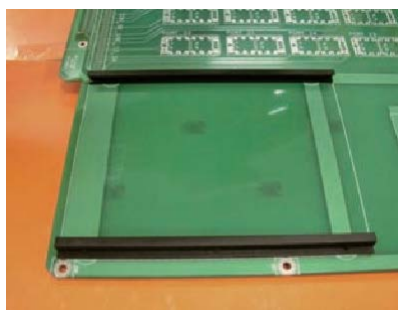

- ◆ MATERIAL: NYLON 66 (UL)
- ◆ FLAME CLASS: 94V-2/94V-0
- ◆ COLOR: NATURAL/BLACK
- ◆ UNIT: mm

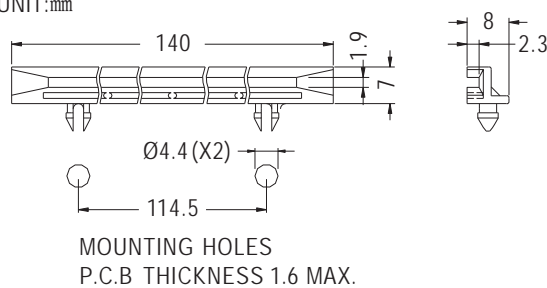

PART NO	PACKAGE
CGA-140	100

