

SCREW

- ◆ MATERIAL: NYLON 66 (UL)/PC (UL)
- ◆ FLAME CLASS: 94V-2/94V-0
- ◆ COLOR: NATURAL/BLACK
- ◆ UNIT: mm

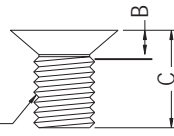

PART NO	A	B	C	T	PACKAGE
M3-5F	5.3	1.2	4.8	M3X0.5P	1000
M3-5.3F	5.3	1.6	5.0		
M3-6F	5.6	1.6	6.0		
M3-8F			8.0		
M3-10F			10.0		
M3-12F			12.0		
M3-14F			14.0		
M3-4.2F	6.0	1.7	4.2	2000	
M4-8F	7.6	2.0	8.0	M4X0.7P	1000
M4-10F			10.0		
M4-12F			12.0		
M4-14F			14.0		
M4-16F			16.0		
M4-18F	7.65	2.7	18.0	M5X0.8P	1000
M5-15F	9.1	9.1	14.8		

SCREW

- ◆ MATERIAL: NYLON 66 (UL)
- ◆ FLAME CLASS: 94V-2/94V-0
- ◆ COLOR: NATURAL/BLACK
- ◆ UNIT: mm

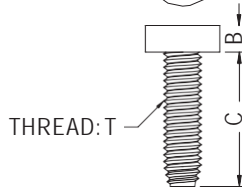
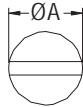
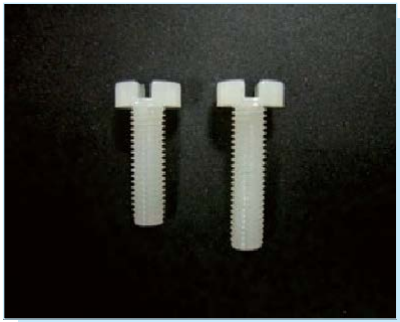

PART NO	A	B	C	T	PACKAGE
MI3-5N	5.5	2.0	5.0	M3X0.5P	1000
MI3-6N			6.0		
MI3-8N			8.0		
MI3-10N			10.0		
MI3-12N			12.0		
MI 4-10N	7.0	2.7	10.0	M4X0.7P	1000

SCREW

- ◆ MATERIAL: NYLON 66 (UL)/PC (UL)
- ◆ FLAME CLASS: 94V-2/94V-0
- ◆ COLOR: NATURAL
- ◆ UNIT: mm

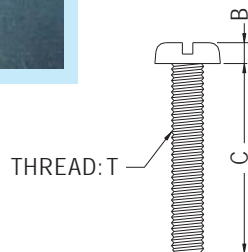

PART NO	A	B	C	T	PACKAGE
M3.5-10	6.9	2.2	10.0	M3.5X0.6P	1000
M3.5-15			15.0		
M3.5-20			20.0		
M3.5-25			25.0		
M3.5-30			30.0		
S440-6	5.2	2.1	6.4	4-40 UNC	2000
S440-8			8.0		
S440-9			9.5		
S440-12			12.7		
S440-15			15.5		
S632-6	6.7	2.5	6.35	6-32 UNC	2000
S632-8			8.0		
S632-9			9.5		
S632-12			12.7		
S632-15			15.9		
S632-19			19.1		
S632-25			25.4		
S632-28			28.0		

