

P.C.B TERMINAL

- ◆ MATERIAL:TIN PLATED BRASS
- ◆ UNIT:mm

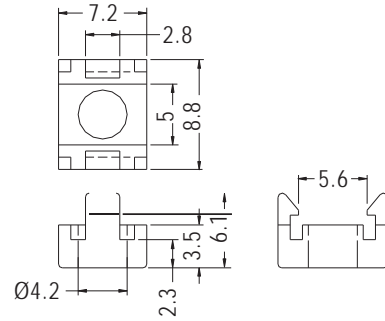
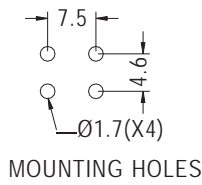
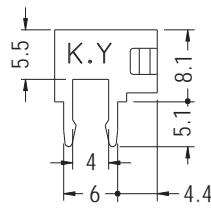
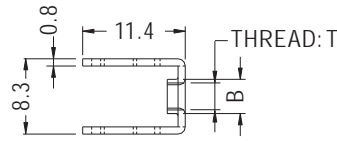
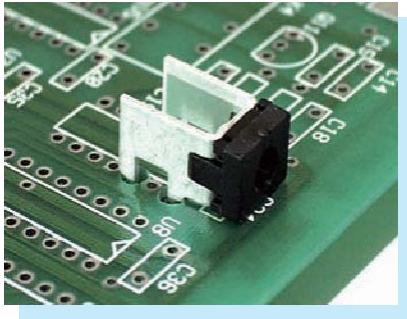

PARTNO	B	T	PACKAGE
PCB-4	3.5	M3X0.5P	1000
PCB-4(M4)	4.4	M4X0.7P	
PCB-4(632)		6-32UNC	
(ASSY)			
PCB-4(M3)F	PCB-4+PCB-4CV		
PCB-4(M4)F	PCB-4(M4)+PCB-4CV		
PCB-4(632)F	PCB-4(632)+PCB-4CV		

PARTNO	PACKAGE
PCB-4CV	1000

P.C.B TERMINAL

- ◆ MATERIAL:TIN PLATED BRASS
- ◆ UNIT:mm

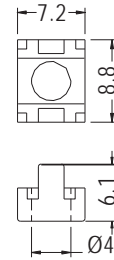
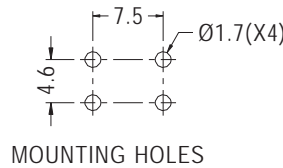
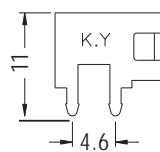
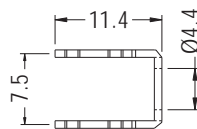
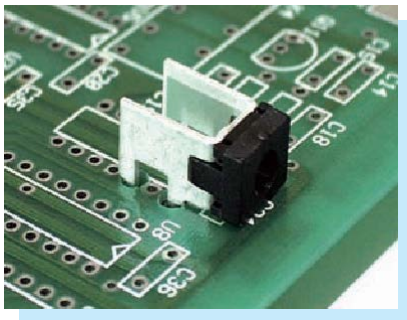

PCB-4CV

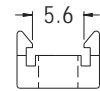

PART NO	PACKAGE
PCB-21(4.4)	1000
(ASSY)	
PCB-21(4.4)F	PCB-21(4.4)+PCB-4CV

P.C.B TERMINAL

- ◆ MATERIAL:TIN PLATED STEEL
- ◆ UNIT:mm

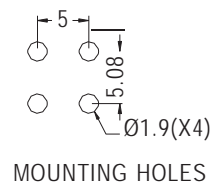
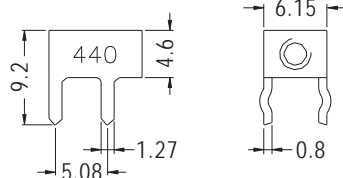
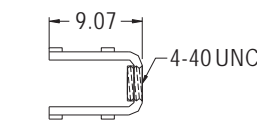

MOUNTING HOLES

PART NO	PACKAGE
PCB-47ST(440)	1000

