

Ø 10 - 12 mm

TOPTEK®  
HARDWARE ELECTRONIC MANUFACTURER



## Z-TOP-Q12BJ-DL-N



Diameter: Ø 12mm  
Color: R, G, Y, O, B, W  
Switch Rating: 2A/36VAC  
Contact Configuration: 1NO  
Operation Type: Maintained  
Lamp type: Dot illuminated (LED)  
The Crust Material:

- Stainless steel
- Copper plating

IP Degree: IP67, IK10

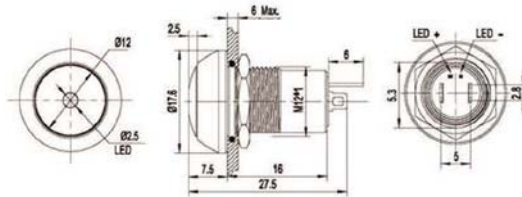

14  
\*  
41

## Z-TOP-12BJ-L-N



Diameter: Ø 12mm  
Color: R, G, Y, O, B, W  
Switch Rating: 2A/36VDC  
Contact Configuration: 1NO  
Operation Type: Maintained  
The Crust Material:

- Stainless steel
- Copper plating

IP Degree: IP67, IK08

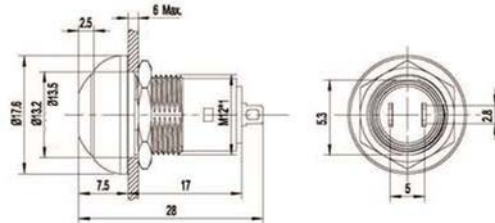

## Z-TOP-12F-10EM



Diameter: Ø 12mm  
Color: R, G, Y, O, B, W  
Switch Rating: 2A/36VDC  
Contact Configuration: 1NO  
Operation Type: Momentary  
Lamp type: Ring illuminated (LED)  
The Crust Material: Stainless steel  
Degree: IP67, IK08

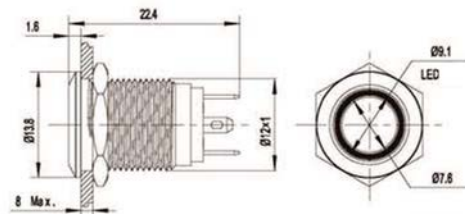

## Z-TOP-12H-10EM



Diameter: Ø 12mm  
Color: R, G, Y, O, B, W  
Switch Rating: 2A/36VDC  
Contact Configuration: 1NO  
Operation Type: Momentary  
Lamp type: Ring illuminated (LED)  
The Crust Material: Stainless steel  
Degree: IP67, IK08

