

Contact Resistance:  $\leq 0.03 \Omega$   
 Insulation Resistance:  $\geq 100M \Omega$   
 Withstand Voltage: 500V, AC/minute  
 Temperature Range:  $-25^{\circ}C \sim +70^{\circ}C$

Rated Load: 30V DC 0.3A  
 Insertion and Extraction Force: 3N ~ 30N  
 Terminal Strength:  $\geq 20N$   
 Life:  $\geq 5000$  Cycles

## R-311K

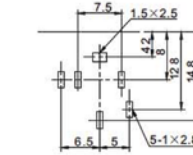
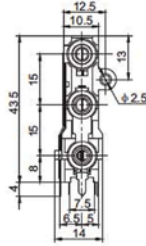

## R-312

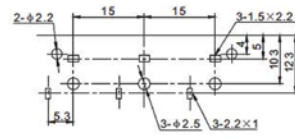
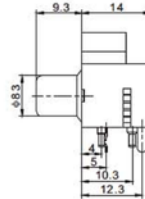
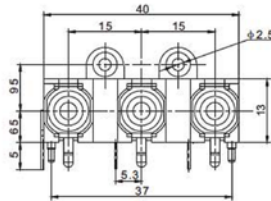

## R-312A

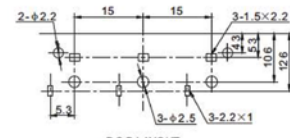
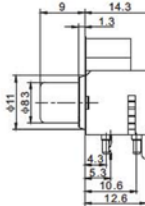
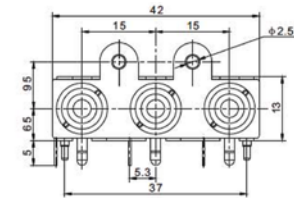

## R-313

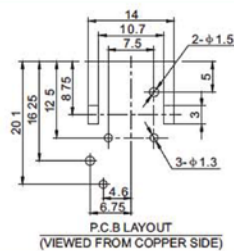
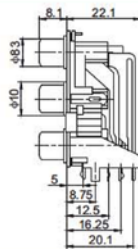
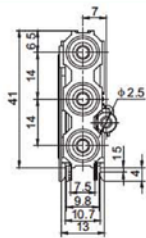

## R-313A

