

Contact Resistance: $\leq 0.03 \Omega$
 Insulation Resistance: $\geq 100M \Omega$
 Withstand Voltage: 500V, AC/minute
 Temperature Range: $-25^{\circ}\text{C} \sim +70^{\circ}\text{C}$

Insertion and Extraction Force: 3N ~ 30N (RCA Jack)
 Insertion and Extraction Force: 4N ~ 40N (DIN (Jack))
 Terminal Strength: $\geq 20N$
 Rated Load: 30V DC 0.3A
 Life: ≥ 5000 Cycles

TOPTEK®
 HARDWARE ELECTRONIC MANUFACTURER

www.toptek-co.com

R-DIN-303K

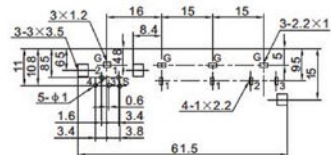
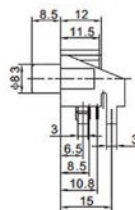
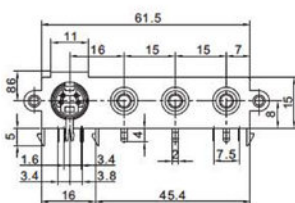

PC.B LAYOUT
(VIEWED FROM COPPER SIDE)

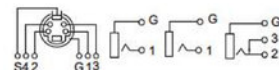

7
*
51

R-DIN-304A

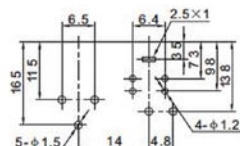
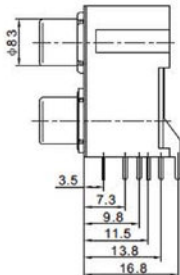
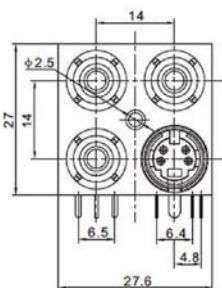

PC.B LAYOUT
(VIEWED FROM COPPER SIDE)

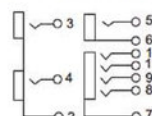

R-DIN-305

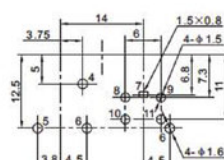
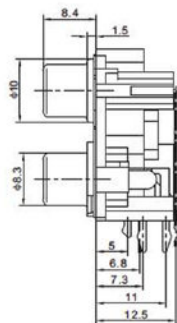
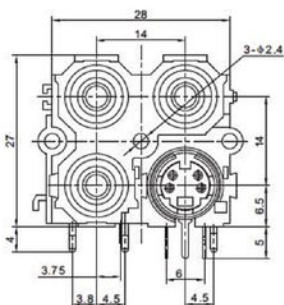

PC.B LAYOUT
(VIEWED FROM COPPER SIDE)

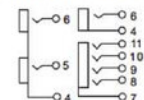

R-DIN-306A

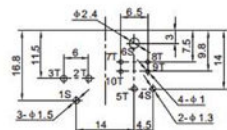
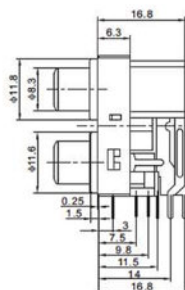
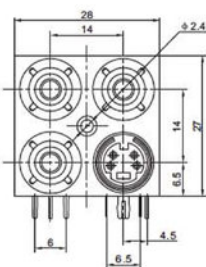

PC.B LAYOUT
(VIEWED FROM COPPER SIDE)

