

# ▶ TOGGLE SWITCH

Toggle Switch

**TOPTTEK®**

HARDWARE ELECTRONIC COMPONENTS



www.toptek-co.com



**Specifications**

Rating: 10A 125V AC; 6A 250V AC / 15A 125V AC; 10A 250V AC / 20A 125V AC; 15A 250V AC | Contact Resistance: 50mΩ Max |  
 Insulation Resistance: 500VDC 1000MΩ min | Dielectric Strength: 1500V AC for one minute | Operation Temperature: -25°C to +85°C  
 Electrical Life: ≥ 10,000 Cycles

**T3A-102-112-103-113-123**

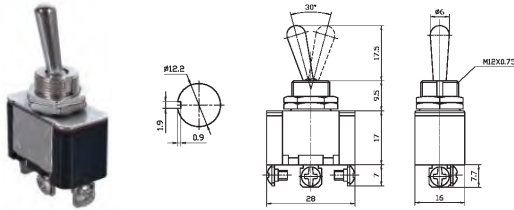

T3A-102 ON-ON      T3A-113 ON-OFF-(ON)  
 T3A-112 ON-(ON)    T3A-123 (ON)-OFF-(ON)  
 T3A-103 ON-OFF-ON    SPDT 3P

**T3A-101-P**

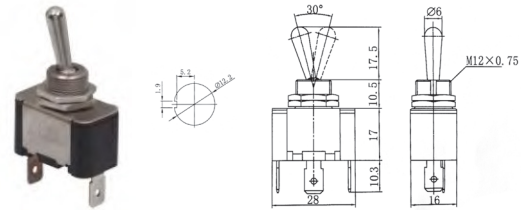

T3A-101-P ON-OFF  
 SPST-2P

**T3A-102-112-103-113-123-P**

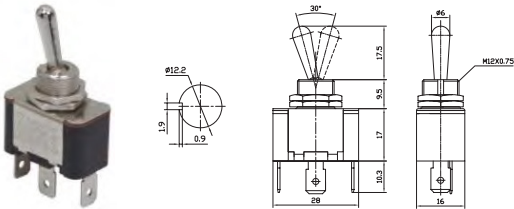

T3A-102-P ON-ON      T3C-113 ON-OFF-(ON)-A  
 T3A-112-P ON-(ON)    T3C-123 (ON)-OFF-(ON)-A  
 T3A-103-P ON-OFF-ON    SPDT 3P

**T3B-101**

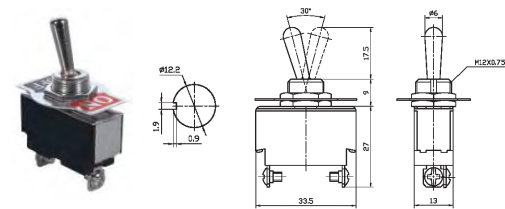

T3B-101 ON-OFF  
 SPST 2P

**T3B-102-112-103-113-123**

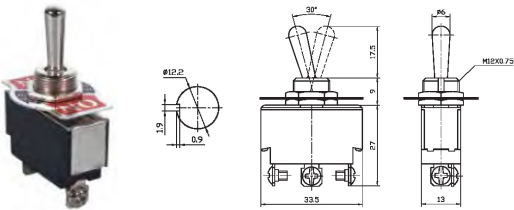

T3B-102 ON-ON      T3B-113 ON-OFF-(ON)  
 T3B-112 ON-(ON)    T3B-123 (ON)-OFF-(ON)  
 T3B-103 ON-OFF-ON    SPDT 3P

**T3B-201**

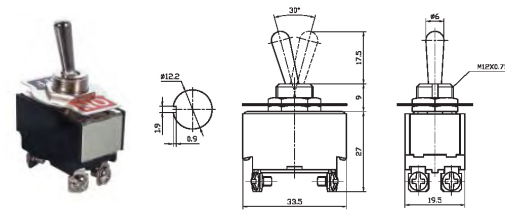

T3B-201 ON-OFF

**T3B-202-212-203-213-223**

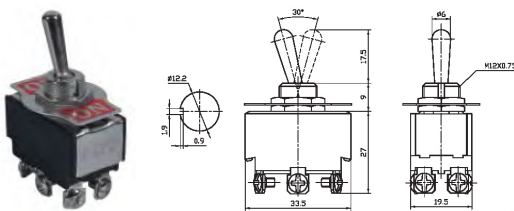

T3B-202 ON-ON      T3B-213 ON-OFF-(ON)  
 T3B-212 ON-(ON)    T3B-223 (ON)-OFF-(ON)  
 T3B-203 ON-OFF-ON    DPDT 6P

**T-32**

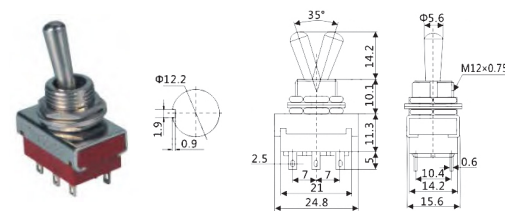

T-32 ON-ON  
 DPDT 6P  
 10A 125VAC; 5A 250VAC