

# Anti-Vandal Switch

**TOPTEK®**

HARDWARE ELECTRONIC MANUFACTURER



[www.toptek-co.com](http://www.toptek-co.com)

TOPTEK srl  
10015 - IVREA (TO) - ITALY  
tel. +39 0125 251 211 - fax +39 0341 367 607  
[info@toptek-co.com](mailto:info@toptek-co.com)

Ø 10 - 12 mm

TOPTEK®  
HARDWARE ELECTRONIC MANUFACTURER



## C-TOP-12B



Diameter: Ø 12mm  
Color: R, G, Y, O, B, W  
Switch Rating: 2A/36VDC  
Contact Configuration: 1NO  
Operation Type: Momentary  
The Crust Material: PC  
IP Degree: IP67, IK08

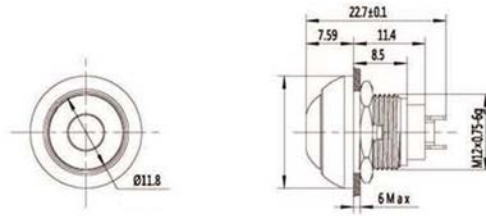

14  
\*  
37

## C-TOP-12B-DM



Diameter: Ø 12mm  
Color: R, G, Y, O, B, W  
Switch Rating: 2A/36VDC  
Contact Configuration: 1NO  
Operation Type: Momentary  
The Crust Material: PC  
IP Degree: IP67, IK08

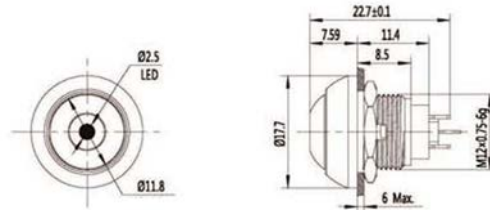

## C-TOP-12B-L



Diameter: Ø 12mm  
Color: R, G, Y, O, B, W  
Switch Rating: 2A/36VDC  
Contact Configuration: 1NO  
Operation Type: Maintained  
The Crust Material: PC  
IP Degree: IP67, IK08

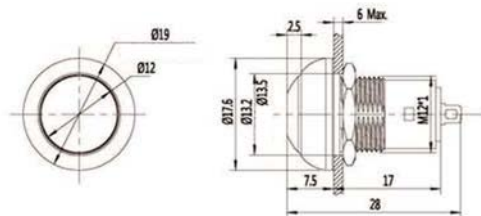

## C-TOP-12B-DL



Diameter: Ø 12mm  
Color: R, G, Y, O, B, W  
Switch Rating: 2A/36VDC  
Contact Configuration: 1NO  
Operation Type: Maintained  
The Crust Material: PC  
IP Degree: IP67, IK08

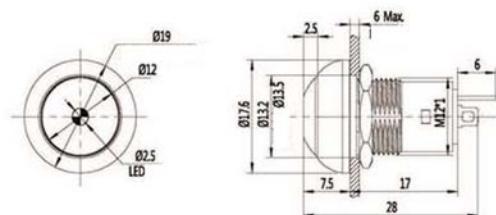

# CONNECTOR MANUFACTURERS

**TOPTEK®**  
HARDWARE ELECTRONIC MANUFACTURER

www.toptek-co.com

Ø 10 - 12 mm

## W-TOP-12S



Diameter: Ø 12mm  
Color: R, G, Y, O, B, W  
Switch Rating: 2A/36VDC  
Contact Configuration: 1NO  
Operation Type: Momentary  
The Crust Material: PC  
IP Degree: IP67, IK08

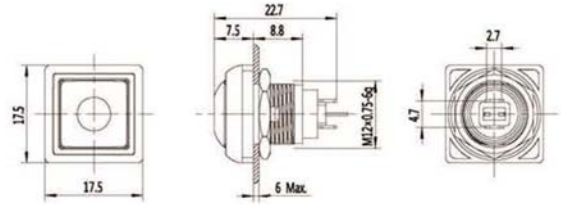

## W-TOP-12S-DM



Diameter: Ø 12mm  
Color: R, G, Y, O, B, W  
Switch Rating: 2A/36VDC  
Contact Configuration: 1NO  
Operation Type: Momentary  
The Crust Material: PC  
IP Degree: IP67, IK08

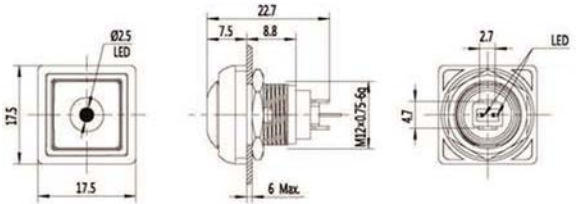

## Z-TOP-10H-11



Diameter: Ø 10mm  
Switch Rating: 3A/250VAC  
Contact Configuration: 1NO 1NC  
Operation Type:  
• Momentary  
• Maintained  
The Front Shape: High  
The Crust Material:  
• Stainless steel  
IP Degree: IP67, IK10

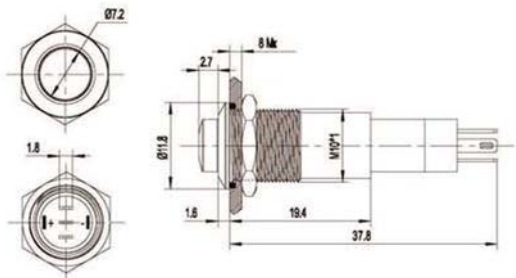

## Z-TOP-10H-11E



Diameter: Ø 10mm  
Switch Rating: 3A/250VAC  
Contact Configuration: 1NO 1NC  
Operation Type:  
• Momentary  
• Maintained  
The Front Shape: High  
Lamp type: Ring illuminated (LED)  
The Crust Material:  
• Stainless steel  
IP Degree: IP67, IK10

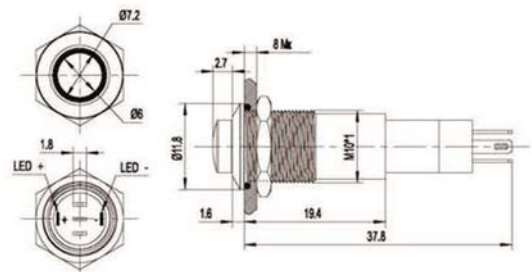

Ø 10 - 12 mm

**TOPTek®**  
HARDWARE ELECTRONIC MANUFACTURER



www.toptek-co.com

## Z-TOP-10H-11D



Diameter: Ø 10mm  
Switch Rating: 3A/250VAC  
Contact Configuration: 1NO 1NC  
Operation Type:

- Momentary
- Maintained

The Front Shape: High  
Lamp type: Ring illuminated (LED)  
The Crust Material:  
• Stainless steel  
IP Degree: IP67, IK10

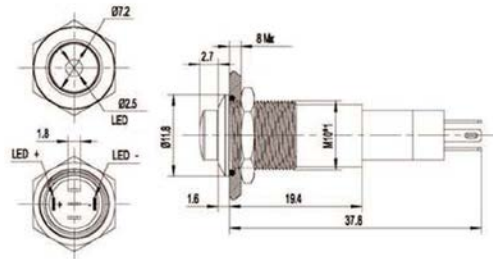

14  
\*  
39

## Z-TOP-12BJ-A



Diameter: Ø 12mm  
Color: R, G, Y, O, B, W  
Switch Rating: 2A/36VDC  
Contact Configuration: 1NO  
Operation Type: Momentary  
The Crust Material: Zinc alloy  
IP Degree: IP67, IK08

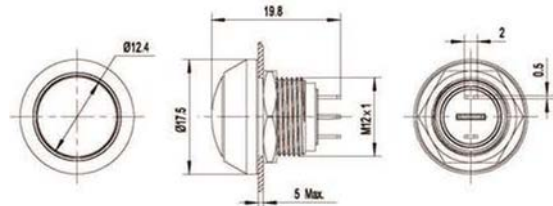

## Z-TOP-12B-A



Diameter: Ø 12mm  
Color: R, G, Y, O, B, W  
Switch Rating: 2A/36VDC  
Contact Configuration: 1NO  
Operation Type: Momentary  
The Crust Material: Zinc alloy  
IP Degree: IP67, IK08

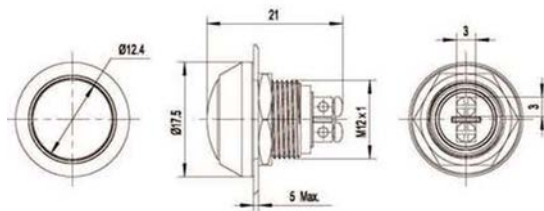

## Z-TOP-12BJ-N



Diameter: Ø 12mm  
Color: R, G, Y, O, B, W  
Switch Rating: 2A/36VDC  
Contact Configuration: 1NO  
Operation Type: Momentary  
The Crust Material: Chromium plated brass  
IP Degree: IP67, IK08

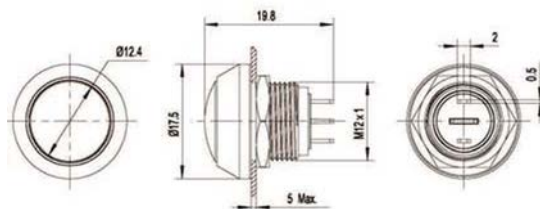

# CONNECTOR MANUFACTURERS

**TOPTEK®**  
HARDWARE ELECTRONIC MANUFACTURER

www.toptek-co.com

Ø 10 - 12 mm

## Z-TOP-12B-N



Diameter: Ø 12mm  
Color: R, G, Y, O, B, W  
Switch Rating: 2A/36VDC  
Contact Configuration: 1NO  
Operation Type: Momentary  
The Crust Material:  
Chromium plated brass  
IP Degree: IP67, IK08

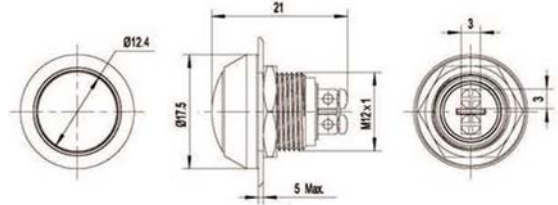

## Z-TOP-12BJ



Diameter: Ø 12mm  
Switch Rating: 2A/36VDC  
Contact Configuration: 1NO  
Operation Type: Momentary  
The Crust Material:  

- Stainless steel
- Copper plating

IP Degree: IP67, IK08

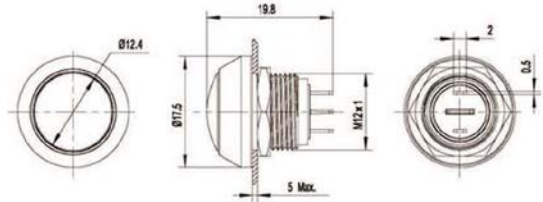

## Z-TOP-Q12B



Diameter: Ø 12mm  
Switch Rating: 2A/36VDC  
Contact Configuration: 1NO  
Operation Type: Momentary  
The Crust Material:  

- Stainless steel
- Copper plating

IP Degree: IP67, IK08

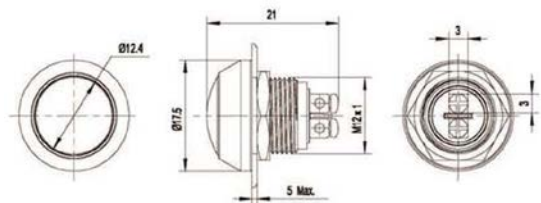

## Z-TOP-Q12BJ-L



Diameter: Ø 12mm  
Switch Rating: 2A/36VDC  
Contact Configuration: 1NO  
Operation Type: Momentary  
The Crust Material:  

- Stainless steel
- Copper plating

IP Degree: IP67, IK08

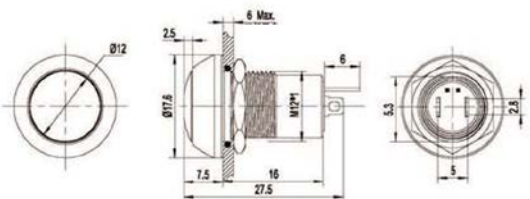

Ø 10 - 12 mm

TOPTEK®  
HARDWARE ELECTRONIC MANUFACTURER



www.toptek-co.com

## Z-TOP-Q12BJ-DL-N



Diameter: Ø 12mm  
Color: R, G, Y, O, B, W  
Switch Rating: 2A/36VAC  
Contact Configuration: 1NO  
Operation Type: Maintained  
Lamp type: Dot illuminated (LED)  
The Crust Material:

- Stainless steel
- Copper plating

IP Degree: IP67, IK10

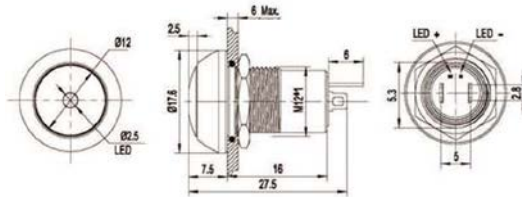

14  
\*  
41

## Z-TOP-12BJ-L-N



Diameter: Ø 12mm  
Color: R, G, Y, O, B, W  
Switch Rating: 2A/36VDC  
Contact Configuration: 1NO  
Operation Type: Maintained  
The Crust Material:

- Stainless steel
- Copper plating

IP Degree: IP67, IK08

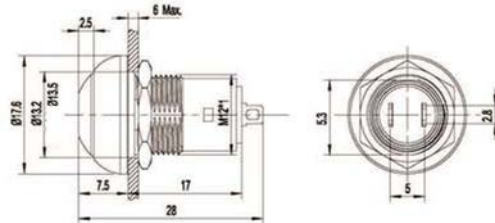

## Z-TOP-12F-10EM



Diameter: Ø 12mm  
Color: R, G, Y, O, B, W  
Switch Rating: 2A/36VDC  
Contact Configuration: 1NO  
Operation Type: Momentary  
Lamp type: Ring illuminated (LED)  
The Crust Material: Stainless steel  
Degree: IP67, IK08

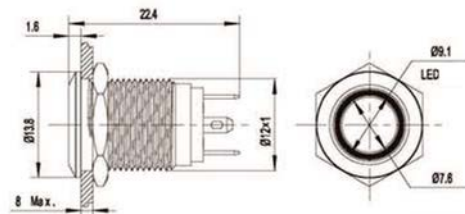

## Z-TOP-12H-10EM



Diameter: Ø 12mm  
Color: R, G, Y, O, B, W  
Switch Rating: 2A/36VDC  
Contact Configuration: 1NO  
Operation Type: Momentary  
Lamp type: Ring illuminated (LED)  
The Crust Material: Stainless steel  
Degree: IP67, IK08

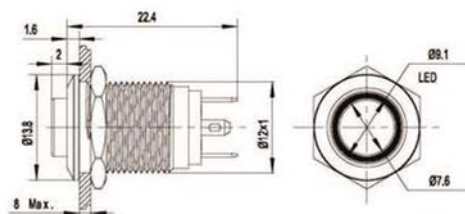



# CONNECTOR MANUFACTURERS

**TOPTEK®**  
HARDWARE ELECTRONIC MANUFACTURER

www.toptek-co.com

Ø 10 - 12 mm

## Z-TOP-12H-10EPM



Diameter: Ø 12mm  
Color: R, G, Y, O, B, W  
Switch Rating: 2A/36VDC  
Contact Configuration: 1NO  
Operation Type: Momentary  
Lamp type: Power symbol illuminated (LED)  
The Crust Material: Stainless steel  
Degree: IP67, IK08

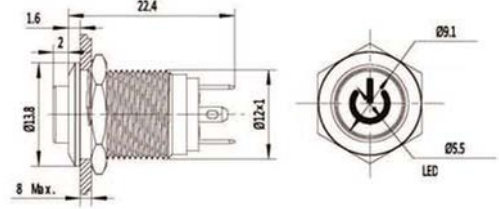

## Z-TOP-12H-10L



Diameter: Ø 12mm  
Switch Rating: 2A/36VDC  
Contact Configuration: 1NO  
Operation Type: Maintained  
The Crust Material:  
• Stainless steel  
IP Degree: IP67, IK08

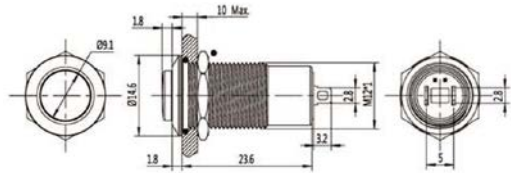

## Z-TOP-12H-10EL



Diameter: Ø 12mm  
Switch Rating: 2A/36VDC  
Contact Configuration: 1NO  
Operation Type: Maintained  
Lamp type: Ring illuminated (LED)  
The Crust Material: Stainless steel  
IP Degree: IP67, IK08

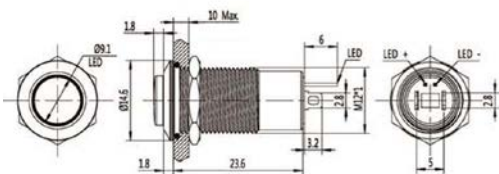

## Z-TOP-12H-10DL



Diameter: Ø 12mm  
Switch Rating: 2A/36VDC  
Contact Configuration: 1NO  
Operation Type: Maintained  
Lamp type: Dot illuminated (LED)  
The Crust Material: Stainless steel  
IP Degree: IP67, IK08

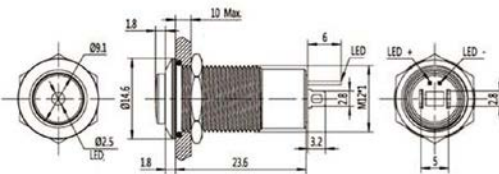

Ø 16 mm

TOPTEK®  
HARDWARE ELECTRONIC MANUFACTURER



## C-TOP-16F-J



Diameter: Ø 16mm  
Switch Rating: 3A/250VAC  
Contact Configuration: 1NO  
Operation Type: Momentary  
The Front Shape: Flat  
The Crust Material:

- Stainless steel
- Copper plating

IP Degree: IP67, IK10

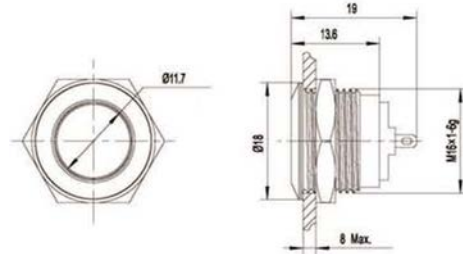

## C-TOP-16B-J



Diameter: Ø 16mm  
Switch Rating: 3A/250VAC  
Contact Configuration: 1NO  
Operation Type: Momentary  
The Front Shape: Ball  
The Crust Material:

- Stainless steel
- Copper plating

IP Degree: IP67, IK10

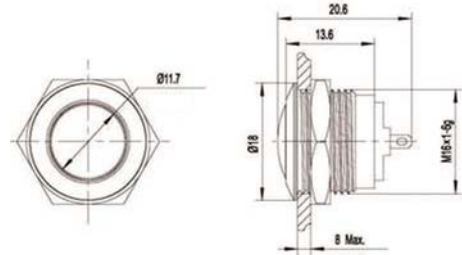

## C-TOP-16H-J



Diameter: Ø 16mm  
Switch Rating: 3A/250VAC  
Contact Configuration: 1NO  
Operation Type: Momentary  
The Front Shape: High  
The Crust Material:

- Stainless steel
- Copper plating

IP Degree: IP67, IK10

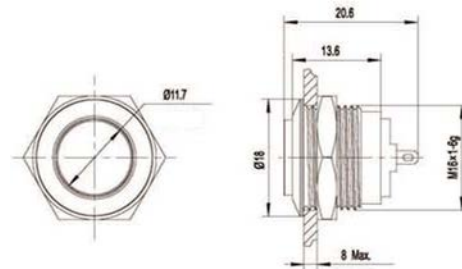

## C-TOP-16F



Diameter: Ø 16mm  
Switch Rating: 3A/250VAC  
Contact Configuration: 1NO  
Operation Type: Momentary  
The Front Shape: Flat  
The Crust Material:

- Stainless steel
- Copper plating

IP Degree: IP67, IK10

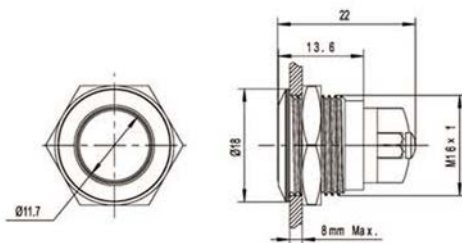



# CONNECTOR MANUFACTURERS

TOPTEK®  
HARDWARE ELECTRONIC MANUFACTURER

www.toptek-co.com

## Ø 16 mm

### C-TOP-16B



Diameter: Ø 16mm  
Switch Rating: 3A/250VAC  
Contact Configuration: 1NO  
Operation Type: Momentary  
The Front Shape: Ball  
The Crust Material:

- Stainless steel
- Copper plating

IP Degree: IP67, IK10

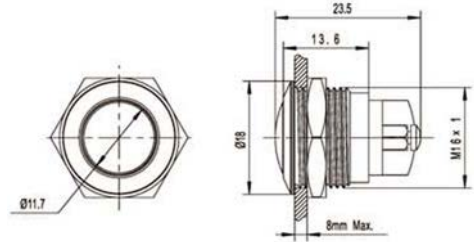

### C-TOP-16H



Diameter: Ø 16mm  
Switch Rating: 3A/250VAC  
Contact Configuration: 1NO  
Operation Type: Momentary  
The Front Shape: High  
The Crust Material:

- Stainless steel
- Copper plating

IP Degree: IP67, IK10

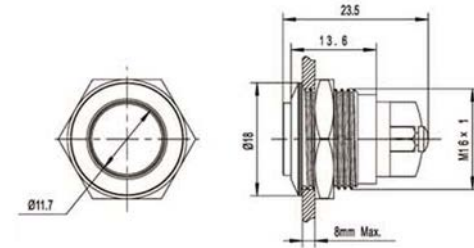

### C-TOP-16FJ-L



Diameter: Ø 16mm  
Switch Rating: 3A/250VAC  
Contact Configuration: 1NO  
Operation Type: Maintained  
The Front Shape: Flat  
The Crust Material:

- Stainless steel

IP Degree: IP67, IK10

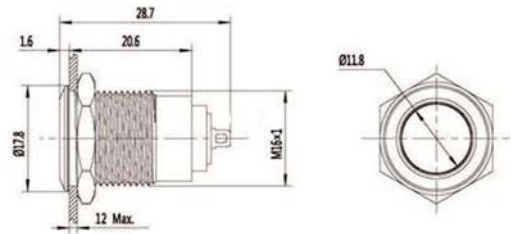

### C-TOP-16BJ-L



Diameter: Ø 16mm  
Switch Rating: 3A/250VAC  
Contact Configuration: 1NO  
Operation Type: Maintained  
The Front Shape: Ball  
The Crust Material:

- Stainless steel

IP Degree: IP67, IK10

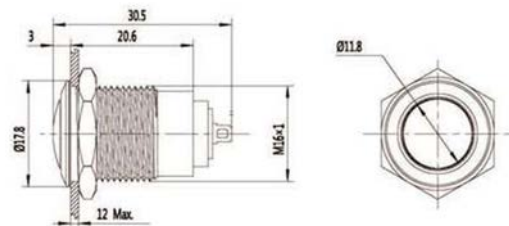

Ø 16 mm

TOPTEK®  
HARDWARE ELECTRONIC MANUFACTURER

## C-TOP-16HJ-L



Diameter: Ø 16mm  
Switch Rating: 3A/250VAC  
Contact Configuration: 1NO  
Operation Type: Maintained  
The Front Shape: High  
The Crust Material:  

- Stainless steel

 IP Degree: IP67, IK10

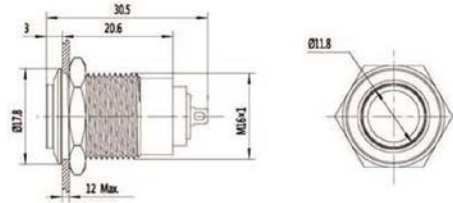

14  
\*  
45

## C-TOP-16F-10EM



Diameter: Ø 16mm  
Color: R, G, Y, O, B, W  
Switch Rating: 3A/250VAC  
Contact Configuration: 1NO  
Operation Type: Momentary  
The Front Shape: Flat  
Lamp type: Ring illuminated (LED)  
The Crust Material:  

- Stainless steel
- Copper plating

 IP Degree: IP67, IK10

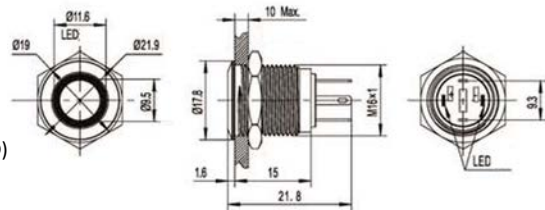

## C-TOP-16H-10EM



Diameter: Ø 16mm  
Switch Rating: 3A/250VAC  
Contact Configuration: 1NO  
Operation Type: Momentary  
The Front Shape: High  
Lamp type: Ring illuminated (LED)  
The Crust Material:  

- Stainless steel
- Copper plating

 IP Degree: IP67, IK10

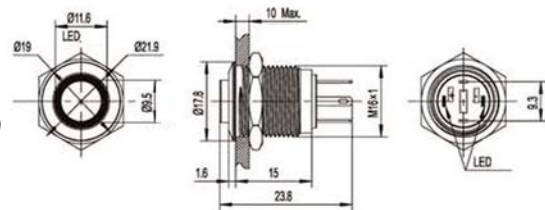

## C-TOP-16F-10EPM



Diameter: Ø 16mm  
Switch Rating: 3A/250VAC  
Contact Configuration: 1NO  
Operation Type: Momentary  
The Front Shape: Flat  
Lamp type: Power symbol illuminated (LED)  
The Crust Material:  

- Stainless steel
- Copper plating

 IP Degree: IP67, IK10

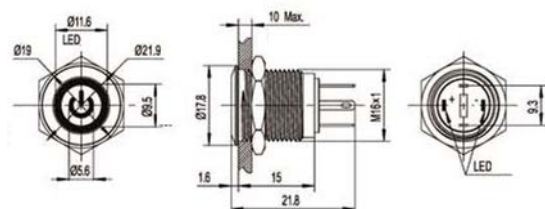

# CONNECTOR MANUFACTURERS



Ø 16 mm

## C-TOP-16F-10DM



Diameter: Ø 16mm  
 Switch Rating: 3A/250VAC  
 Contact Configuration: 1NO  
 Operation Type: Momentary  
 The Front Shape: Flat  
 Lamp type: Dot illuminated (LED)  
 The Crust Material:  
 • Stainless steel  
 • Copper plating  
 IP Degree: IP67, IK10

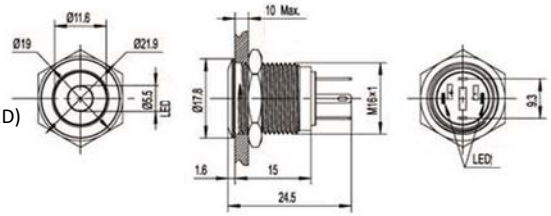

## E-TOP-16FJ-L-S



Diameter: Ø 16mm  
 Switch Rating: 3A/250VAC  
 Contact Configuration: 1NO 1NC  
 Operation Type:  
 • Momentary  
 • Maintained  
 The Front Shape: Flat  
 The Crust Material:  
 • Stainless steel  
 IP Degree: IP67, IK10

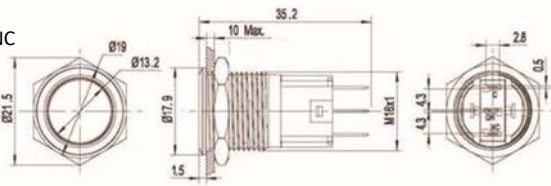

## E-TOP-16H



Diameter: Ø 16mm  
 Switch Rating: 3A/250VAC  
 Contact Configuration: 1NO 1NC  
 Operation Type:  
 • Momentary  
 • Maintained  
 The Front Shape: Flat  
 The Crust Material:  
 • Stainless steel  
 IP Degree: IP67, IK10

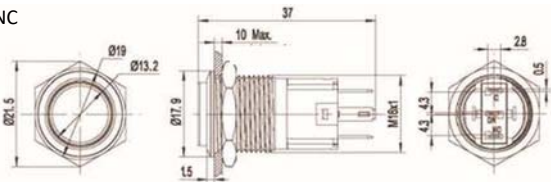

## E-TOP-16F-11EP



Diameter: Ø 16mm  
 Switch Rating: 3A/250VAC  
 Contact Configuration: 1NO 1NC  
 Operation Type:  
 • Momentary  
 • Maintained  
 The Front Shape: Flat  
 Lamp type: Power symbol illuminated (LED)  
 The Crust Material: Stainless steel  
 IP Degree: IP67, IK10

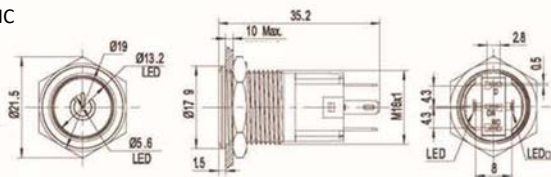

Ø 16 mm

**TOPTEK®**  
HARDWARE ELECTRONIC MANUFACTURER



www.toptek-co.com

## E-TOP-16F-11E



Diameter: Ø 16mm  
Color: R, G, Y, O, B, W  
Switch Rating: 3A/250VAC  
Contact Configuration: 1NO 1NC  
Operation Type:

- Momentary
- Maintained

The Front Shape: Flat

Lamp type: Ring illuminated (LED)

The Crust Material: Stainless steel

IP Degree: IP67, IK10

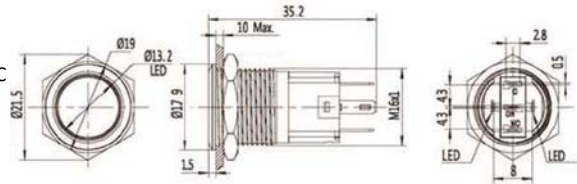

14  
\*  
47

## E-TOP-16H-11E



Diameter: Ø 16mm  
Color: R, G, Y, O, B, W  
Switch Rating: 3A/250VAC  
Contact Configuration: 1NO 1NC  
Operation Type:

- Momentary
- Maintained

The Front Shape: High

Lamp type: Ring illuminated (LED)

The Crust Material: Stainless steel

IP Degree: IP67, IK10

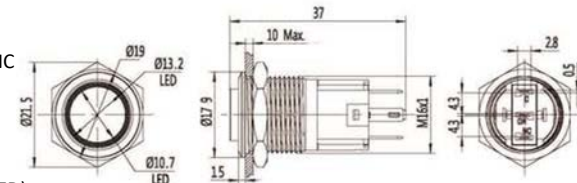

## E-TOP-16F-11D



Diameter: Ø 16mm  
Color: R, G, Y, O, B, W  
Switch Rating: 3A/250VAC  
Contact Configuration: 1NO 1NC  
Operation Type:

- Momentary
- Maintained

The Front Shape: Flat

Lamp type: Dot illuminated (LED)

The Crust Material: Stainless steel

IP Degree: IP67, IK10

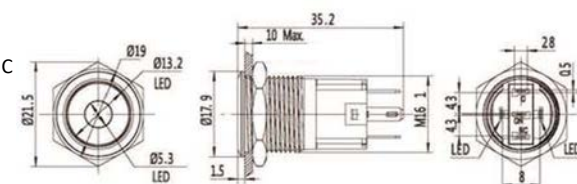

## E-TOP-16H-11D



Diameter: Ø 16mm  
Color: R, G, Y, O, B, W  
Switch Rating: 3A/250VAC  
Contact Configuration: 1NO 1NC  
Operation Type:

- Momentary
- Maintained

The Front Shape: High

Lamp type: Dot illuminated (LED)

The Crust Material: Stainless steel

IP Degree: IP67, IK10

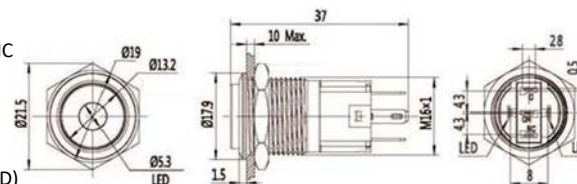

# CONNECTOR MANUFACTURERS

TOPTEK®  
HARDWARE ELECTRONIC MANUFACTURER

www.toptek-co.com

## Ø 19 mm

### G-TOP-19F



Diameter: Ø 19mm  
Switch Rating: 5A/250VAC  
Contact Configuration: 1NO  
Operation Type: Momentary  
The Front Shape: Flat  
The Crust Material:

- Stainless steel

IP Degree: IP68, IK10

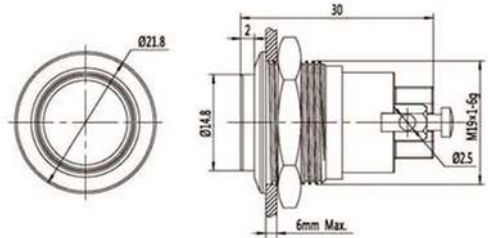

### G-TOP-19B



Diameter: Ø 19mm  
Switch Rating: 5A/250VAC  
Contact Configuration: 1NO  
Operation Type: Momentary  
The Front Shape: Ball  
The Crust Material:

- Stainless steel

IP Degree: IP68, IK10

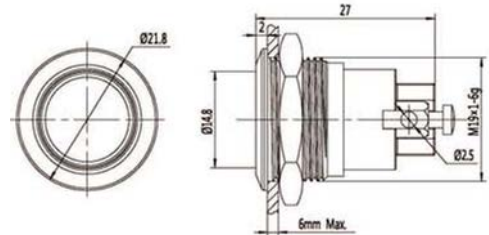

### G-TOP-19H



Diameter: Ø 19mm  
Switch Rating: 5A/250VAC  
Contact Configuration: 1NO  
Operation Type: Momentary  
The Front Shape: High  
The Crust Material:

- Stainless steel

IP Degree: IP68, IK10

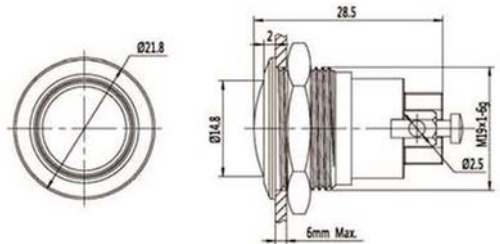

### P-TOP-19B-2



Diameter: Ø 19mm  
Switch Rating: 5A/250VAC  
Contact Configuration: 1NO  
Operation Type: Momentary  
The Front Shape: Flat  
The Crust Material:

- Stainless steel
- Copper plating

IP Degree: IP67, IK10

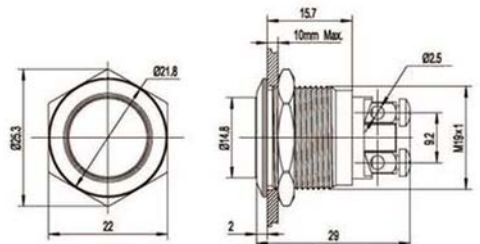



Ø 19 mm

TOPTEK®  
HARDWARE ELECTRONIC MANUFACTURER



## P-TOP-19B



Diameter: Ø 19mm  
Switch Rating: 5A/250VAC  
Contact Configuration: 1NO  
Operation Type:

- Momentary

The Front Shape: Ball  
The Crust Material:

- Stainless steel
- Copper plating

IP Degree: IP67, IK10

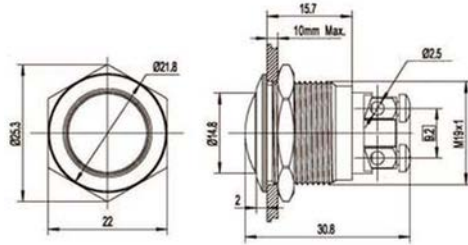

14  
\*  
49

## P-TOP-19B-4



Diameter: Ø 19mm  
Switch Rating: 5A/250VAC  
Contact Configuration: 1NO  
Operation Type:

- Momentary

The Front Shape: High  
The Crust Material:

- Stainless steel
- Copper plating

IP Degree: IP67, IK10

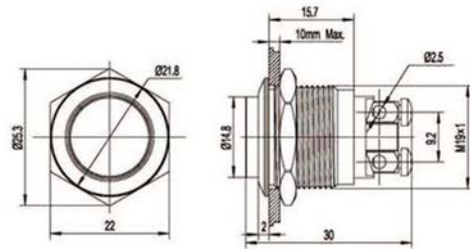

## P-TOP-19B-2-J



Diameter: Ø 19mm  
Switch Rating: 5A/250VAC  
Contact Configuration: 1NO  
Operation Type:

- Momentary

The Front Shape: Flat  
The Crust Material:

- Stainless steel
- Copper plating

IP Degree: IP67, IK10

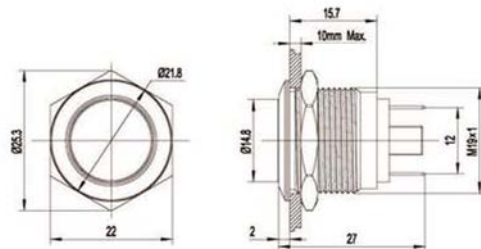

## P-TOP-19B-J



Diameter: Ø 19mm  
Switch Rating: 5A/250VAC  
Contact Configuration: 1NO  
Operation Type:

- Momentary

The Front Shape: Ball  
The Crust Material:

- Stainless steel
- Copper plating

IP Degree: IP67, IK10

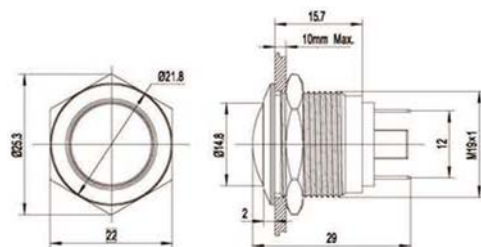

# CONNECTOR MANUFACTURERS

**TOPTEK®**  
HARDWARE ELECTRONIC MANUFACTURER

www.toptek-co.com

Ø 19 mm

## P-TOP-19B-4-J



Diameter: Ø 19mm  
Switch Rating: 5A/250VAC  
Contact Configuration: 1NO  
Operation Type: Momentary  
The Front Shape: High  
The Crust Material:  

- Stainless steel
- Copper plating

 IP Degree: IP67, IK10

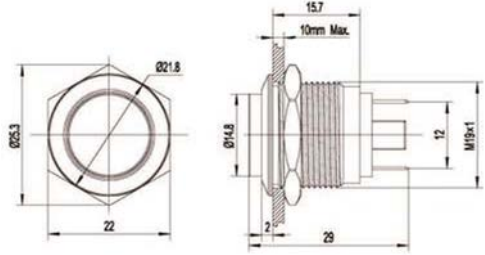

## C-TOP-19F-11L-S



Diameter: Ø 19mm  
Switch Rating: 5A/250VAC  
Contact Configuration: 1NO 1NC/  
2NO 2NC  
Operation Type:  

- Momentary
- Maintained (Z)

 The Front Shape: Flat  
The Crust Material: Stainless steel  
IP Degree: IP67, IK10

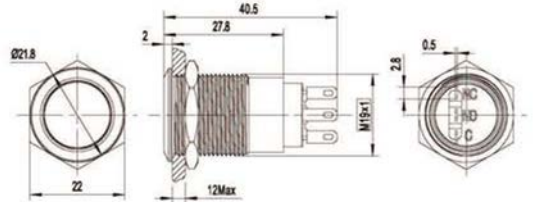

## C-TOP-19B-11L-S



Diameter: Ø 19mm  
Switch Rating: 5A/250VAC  
Contact Configuration: 1NO 1NC/  
2NO 2NC  
Operation Type:  

- Momentary
- Maintained (Z)

 The Front Shape: Ball  
The Crust Material: Stainless steel  
IP Degree: IP67, IK10

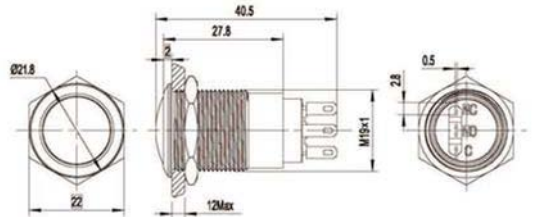

## C-TOP-19H-11L-S



Diameter: Ø 19mm  
Switch Rating: 5A/250VAC  
Contact Configuration: 1NO 1NC/  
2NO 2NC  
Operation Type:  

- Momentary
- Maintained (Z)

 The Front Shape: High  
The Crust Material: Stainless steel  
IP Degree: IP67, IK10

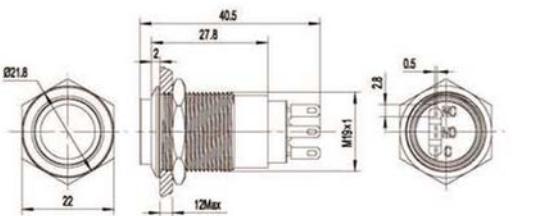

Ø 19 mm

TOPTEK®  
HARDWARE ELECTRONIC MANUFACTURER



www.toptek-co.com

## C-TOP-19F-E



Diameter: Ø 19mm  
 Color: R, G, Y, O, B, W  
 Switch Rating: 5A/250VAC  
 Contact Configuration: 1NO 1NC/ 2NO 2NC  
 Operation Type: Momentary  
 • Maintained(Z)  
 The Front Shape: Flat  
 Lamp type: Ring illuminated(LED)  
 The Crust Material:  
 • Stainless steel  
 • Copper plating  
 IP Degree: IP67, IK10

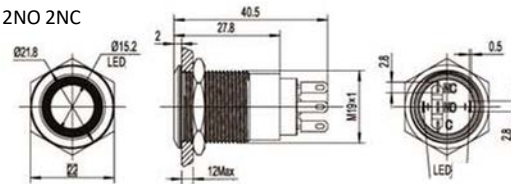

14  
\*  
51

## C-TOP-19F-D



Diameter: Ø 19mm  
 Color: R, G, Y, O, B, W  
 Switch Rating: 5A/250VAC  
 Contact Configuration: 1NO 1NC/ 2NO 2NC  
 Operation Type: Momentary  
 • Maintained(Z)  
 The Front Shape: Flat  
 Lamp type: Dot illuminated(LED)  
 The Crust Material:  
 • Stainless steel  
 IP Degree: IP67, IK10

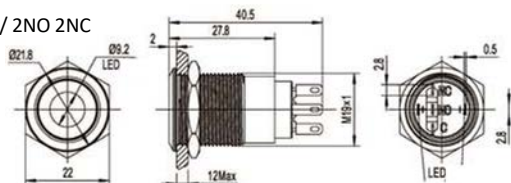

## C-TOP-19B-E



Diameter: Ø 19mm  
 Color: R, G, Y, O, B, W  
 Switch Rating: 5A/250VAC  
 Contact Configuration: 1NO 1NC/ 2NO 2NC  
 Operation Type: Momentary  
 • Maintained(Z)  
 The Front Shape: Ball  
 Lamp type: Ring illuminated(LED)  
 The Crust Material:  
 • Stainless steel  
 • Copper plating  
 IP Degree: IP67, IK10

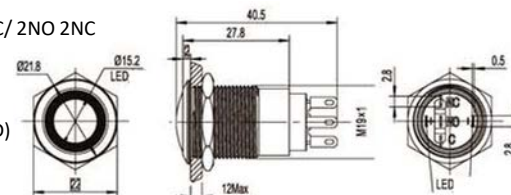

## C-TOP-19BS-10EM



Diameter: Ø 19mm  
 Color: R, G, Y, O, B, W  
 Switch Rating: 5A/250VAC  
 Contact Configuration: 1NO  
 Operation Type: Momentary  
 The Front Shape: Ball  
 Lamp type: Ring illuminated(LED)  
 The Crust Material:  
 • Stainless steel  
 IP Degree: IP67, IK10

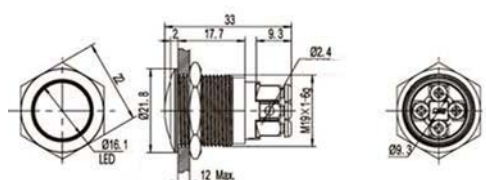

# CONNECTOR MANUFACTURERS

TOPTEK®  
HARDWARE ELECTRONIC MANUFACTURER

www.toptek-co.com

Ø 19 mm

## CA-TOP-19F-EP



Diameter: Ø 19mm  
Color: R, G, Y, O, B, W  
Switch Rating: 5A/250VAC  
Contact Configuration: 1NO 1NC/  
2NO 2NC  
Operation Type: Momentary  
• Maintained(Z)  
The Front Shape: Flat  
Lamp type: Power symbol  
illuminated(LED)  
The Crust Material: Stainless steel  
IP Degree: IP67, IK10

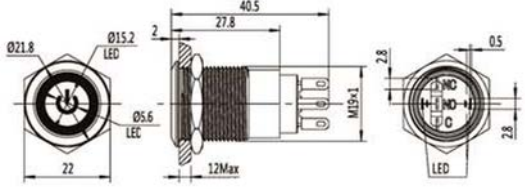

## CA-TOP-19-K



Diameter: Ø 19mm  
Color: R, G, Y, O, B, W  
Switch Rating: 5A/250VAC  
Contact Configuration: 1NO 1NC/  
2NO 2NC  
Operation Type:  
• 2 Position  
• 3 Position  
The Front Shape: Selector  
Light way: Arrow  
The Crust Material: Stainless steel  
IP Degree: IP67, IK10

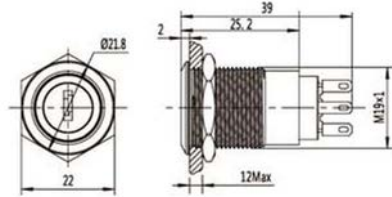

## CA-TOP-19B-SR



Diameter: Ø 19mm  
Switch Rating: 5A/250VAC  
Contact Configuration: 1NO 1NC/ 2NO  
2NC  
Operation Type: Push-Lock Turn-reset  
The Front Shape: Ball  
Light way: Arrow  
The Crust Material: Stainless steel  
IP Degree: IP65, IK10

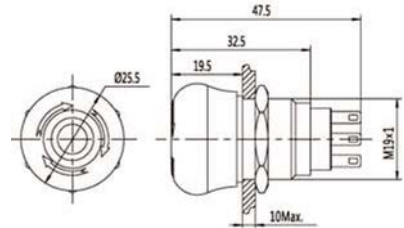

## CA-TOP-19A-SR



Diameter: Ø 19mm  
Switch Rating: 5A/250VAC  
Contact Configuration: 1NO 1NC/ 2NO  
2NC  
Operation Type: Push-Lock Turn-reset  
The Front Shape: Ball  
Light way: Arrow  
The Crust Material: Stainless steel  
IP Degree: IP65, IK10

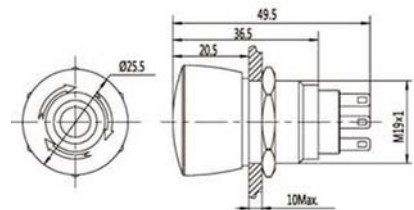

Ø 19 -22 mm

**TOPTEK®**  
HARDWARE ELECTRONIC MANUFACTURER



## CA-TOP-19-X



Diameter: Ø 19mm  
Switch Rating: 5A/250VAC  
Contact Configuration: 1NO 1NC/ 2NO 2NC  
Operation Type:  

- 2 Position
- 3 Position

 The Front Shape: Selector  
 The Crust Material: Stainless steel  
 IP Degree: IP67, IK10

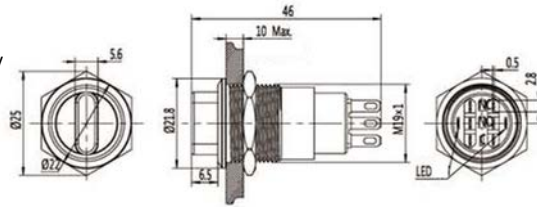

14  
\*  
53

## CA-TOP-19-XA



Diameter: Ø 19mm  
Color: R, G, Y, O, B, W  
Switch Rating: 5A/250VAC  
Contact Configuration: 1NO 1NC/ 2NO 2NC  
Operation Type:  

- 2 Position
- 3 Position

 The Front Shape: Arrow  
 The Crust Material:  

- Stainless steel

 IP Degree: IP67, IK10

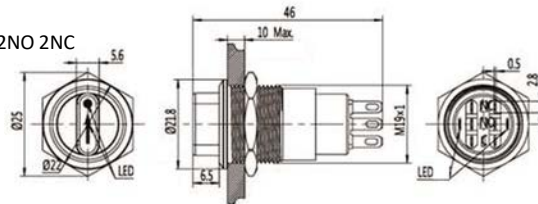

## CA-TOP-19-BZ



Diameter: Ø 19mm  
Its phonation type:  

- Buzzer(M)
- Flicker Buzzer(SM)

 Flash color: R, G, Y, O, B, W  
 Rated Voltage: DC12V/DC24V  

- AC110V/AC220V

 Sound Intensity: ≥ 85dB(0,1\*m)  
 The Front Shape: Flat Round Honeycomb  
 The Crust Material: Stainless steel  
 IP Degree: IP50, IK04

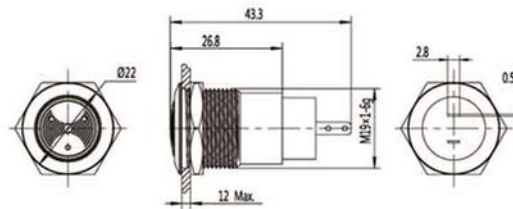

## I-TOP-22F-J



Diameter: Ø 22mm  
Switch Rating: 5A/250VAC  
Contact Configuration: 1NO  
Operation Type: Momentary  
The Front Shape: Flat  
The Crust Material:  

- Stainless steel

 IP Degree: IP67, IK10

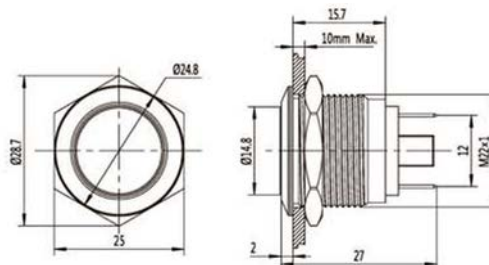



# CONNECTOR MANUFACTURERS

TOPTEK®  
HARDWARE ELECTRONIC MANUFACTURER

www.toptek-co.com

## Ø 22 mm

### I-TOP-22B-J



Diameter: Ø 22mm  
Switch Rating: 5A/250VAC  
Contact Configuration: 1NO  
Operation Type: Momentary  
The Front Shape: Ball  
The Crust Material: Stainless steel  
IP Degree: IP67, IK10

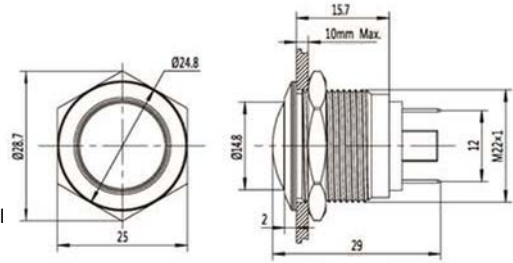

### I-TOP-22H-J



Diameter: Ø 22mm  
Switch Rating: 5A/250VAC  
Contact Configuration: 1NO  
Operation Type: Momentary  
The Front Shape: High  
The Crust Material: Stainless steel  
IP Degree: IP67, IK10

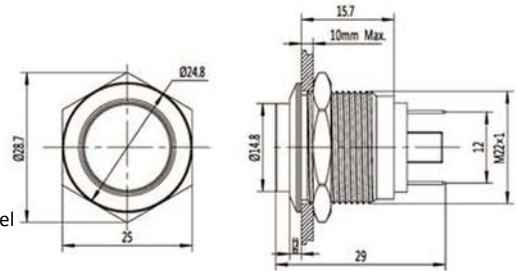

### I-TOP-22F



Diameter: Ø 22mm  
Switch Rating: 5A/250VAC  
Contact Configuration: 1NO  
Operation Type: Momentary  
The Front Shape: Flat  
The Crust Material: Stainless steel  
IP Degree: IP67, IK10

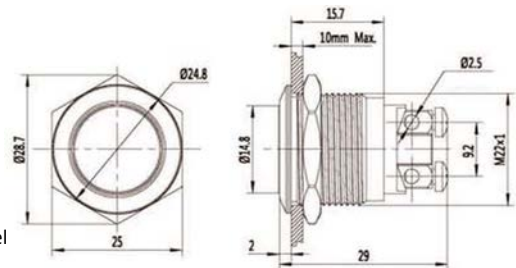

### I-TOP-22B



Diameter: Ø 22mm  
Switch Rating: 5A/250VAC  
Contact Configuration: 1NO  
Operation Type: Momentary  
The Front Shape: Ball  
The Crust Material: Stainless steel  
IP Degree: IP67, IK10

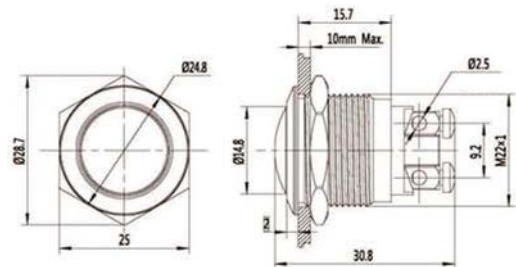

Ø 22 mm

TOPTÉK®  
HARDWARE ELECTRONIC MANUFACTURER

## I-TOP-22H



Diameter: Ø 22mm  
Switch Rating: 5A/250VAC  
Contact Configuration: 1NO  
Operation Type: Momentary  
The Front Shape: High  
The Crust Material: Stainless steel  
IP Degree: IP67, IK10

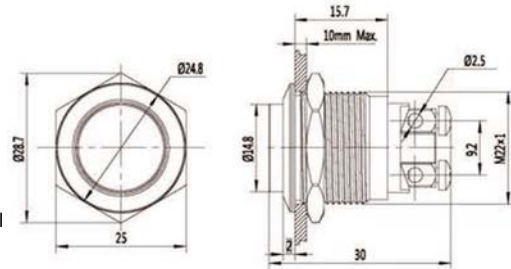

www.toptek-co.com

14  
\*  
55

## I-TOP-22F-11



Diameter: Ø 22mm  
Switch Rating: 5A/250VAC  
Contact Configuration: 1NO 1NC  
Operation Type:  

- Momentary
- Maintained(Z)

 The Front Shape: Flat  
The Crust Material:  

- Stainless steel

 IP Degree: IP67, IK10

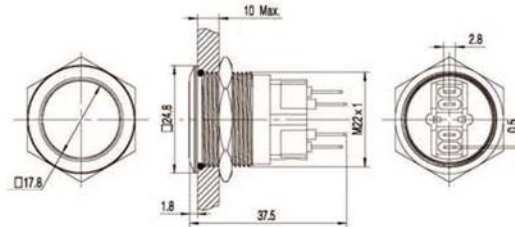

## I-TOP-22B-11



Diameter: Ø 22mm  
Switch Rating: 5A/250VAC  
Contact Configuration: 1NO 1NC  
Operation Type:  

- Momentary
- Maintained(Z)

 The Front Shape: Ball  
The Crust Material:  

- Stainless steel

 IP Degree: IP67, IK10

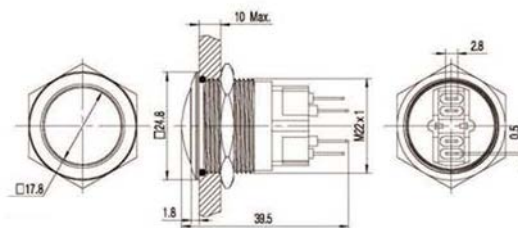

## I-TOP-22H-11



Diameter: Ø 22mm  
Switch Rating: 5A/250VAC  
Contact Configuration: 1NO 1NC  
Operation Type:  

- Momentary
- Maintained(Z)

 The Front Shape: High  
The Crust Material:  

- Stainless steel

 IP Degree: IP67, IK10

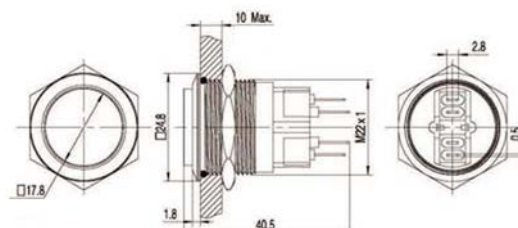

# CONNECTOR MANUFACTURERS

**TOPTEK®**  
HARDWARE ELECTRONIC MANUFACTURER

www.toptek-co.com

Ø 22 mm

## I-TOP-22-11E



Diameter: Ø 22mm  
Color: R, G, Y, O, B, W  
Switch Rating: 5A/250VAC  
Contact Configuration: 1NO 1NC  
Operation Type:

- Momentary
- Maintained(Z)

The Front Shape: Flat  
Lamp type: Ring illuminated (LED)  
The Crust Material: Stainless steel  
IP Degree: IP67, IK10

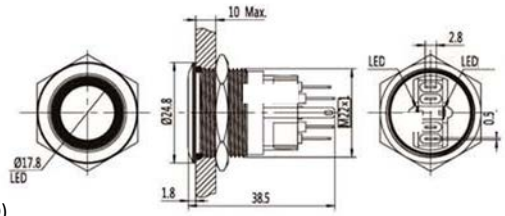

## I-TOP-22-11D



Diameter: Ø 22mm  
Color: R, G, Y, O, B, W  
Switch Rating: 5A/250VAC  
Contact Configuration: 1NO 1NC  
Operation Type:

- Momentary
- Maintained(Z)

The Front Shape: Flat  
Lamp type: Dot illuminated (LED)  
The Crust Material: Stainless steel  
IP Degree: IP67, IK10

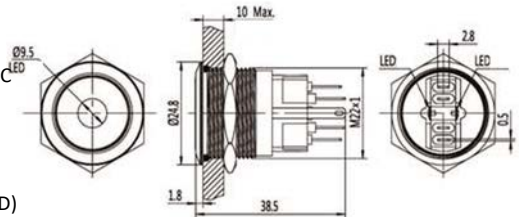

## I-TOP-22-11EP



Diameter: Ø 22mm  
Color: R, G, Y, O, B, W  
Switch Rating: 5A/250VAC  
Contact Configuration: 1NO 1NC  
Operation Type:

- Momentary
- Maintained(Z)

The Front Shape: Flat  
Lamp type: Power symbol illuminated (LED)  
The Crust Material: Stainless steel  
IP Degree: IP67, IK10

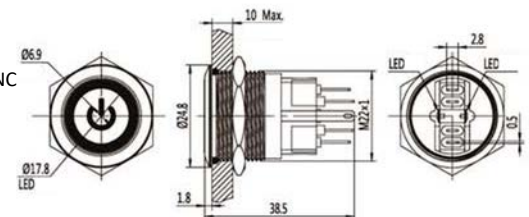

## I-TOP-S1-22F



Diameter: Ø 22mm  
Switch Rating: 5A/250VAC  
Contact Configuration: 1NO 1NC / 2NO 2NC  
Operation Type:

- Momentary
- Maintained(Z)

The Front Shape: Flat  
The Crust Material: Stainless steel  
IP Degree: IP67, IK10

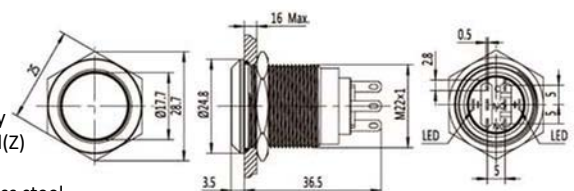

14  
\*  
56

Anti-vandal Switch

Pb

ROHS

Ø 22 mm

TOPTEK®  
HARDWARE ELECTRONIC MANUFACTURER



www.toptek-co.com

## I-TOP-S1-22B



Diameter: Ø 22mm  
Switch Rating: 5A/250VAC  
Contact Configuration:  
1NO 1NC /2NO 2NC  
Operation Type:  

- Momentary
- Maintained(Z)

 The Front Shape: Ball  
The Crust Material: Stainless steel  
IP Degree: IP67, IK10

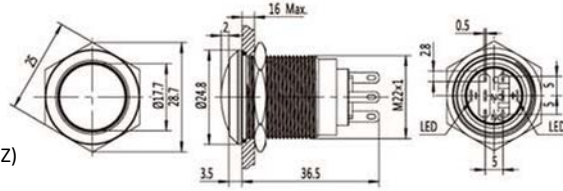

14  
\*  
57

## I-TOP-S1-22H



Diameter: Ø 22mm  
Switch Rating: 5A/250VAC  
Contact Configuration:  
1NO 1NC /2NO 2NC  
Operation Type:  

- Momentary
- Maintained(Z)

 The Front Shape: High  
The Crust Material: Stainless steel  
IP Degree: IP67, IK10

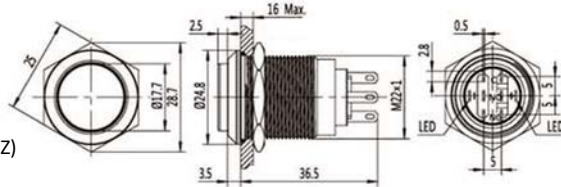

## I-TOP-S1-22F-L



Diameter: Ø 22mm  
Color: R, G, Y, O, B, W  
Switch Rating: 5A/250VAC  
Contact Configuration:  
1NO 1NC /2NO 2NC  
Operation Type:  

- Momentary
- Maintained(Z)

 The Front Shape: Flat  
Lamp type: Dot illuminated (LED)  
The Crust Material: Stainless steel  
IP Degree: IP67, IK10

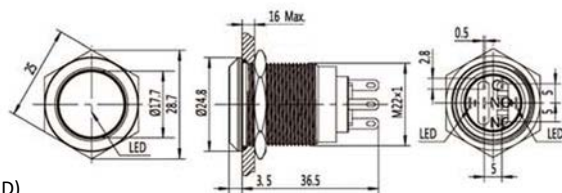

## I-TOP-S1-22F-D



Diameter: Ø 22mm  
Switch Rating: 5A/250VAC  
Contact Configuration:  
1NO 1NC /2NO 2NC  
Operation Type:  

- Momentary
- Maintained(Z)

 The Front Shape: Flat  
Lamp type: Dot illuminated (LED)  
The Crust Material: Stainless steel  
IP Degree: IP67, IK10

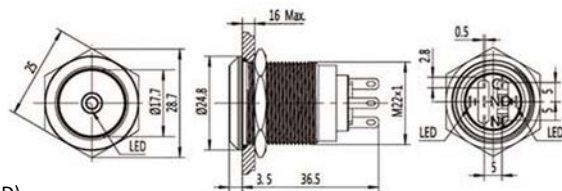



# CONNECTOR MANUFACTURERS

**TOPTek®**  
HARDWARE ELECTRONIC MANUFACTURER

www.toptek-co.com

Ø 22 mm

## I-TOP-S1-22F-E



Diameter: Ø 22mm  
Color: R, G, Y, O, B, W  
Switch Rating: 5A/250VAC  
Contact Configuration:  
1NO 1NC/2NO 2NC  
Operation Type:

- Momentary
- Maintained(Z)

The Front Shape: Flat  
Lamp type: Ring illuminated (LED)  
The Crust Material: Stainless steel  
IP Degree: IP67, IK10

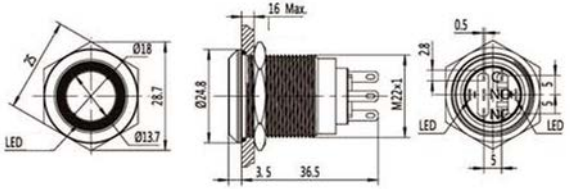

## I-TOP-S1-22B-SR



Diameter: Ø 22mm  
Color: R, G, Y, O, B, W  
Switch Rating: 5A/250VAC  
Contact Configuration: 1NO 1NC  
Operation Type: Push-Lock Turn-reset  
The Front Shape: Ball  
Light way: Arrow  
The Crust Material: Stainless steel  
IP Degree: IP65, IK10

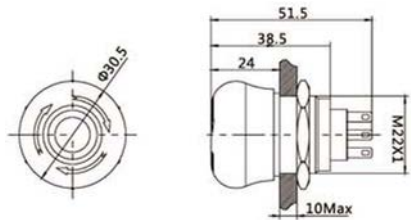

## I-TOP-S1-AWY



Diameter: Ø 22mm  
Switch Rating: 5A/250VAC  
Contact Configuration:  
1NO 1NC /2NO 2NC  
Operation Type:

- Momentary
- Maintained(Z)

The Front Shape: Flat  
The Crust Material: Stainless steel  
IP Degree: IP67, IK10

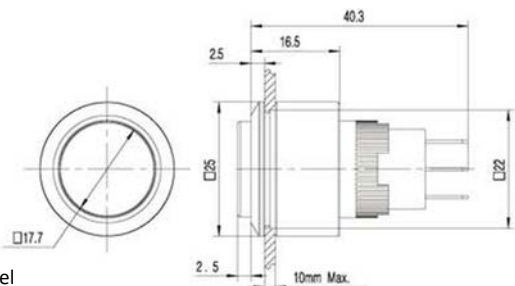

## I-TOP-S1-AWX



Diameter: Ø 22mm  
Color: R, G, Y, O, B, W  
Switch Rating: 5A/250VAC  
Contact Configuration:  
1NO 1NC /2NO 2NC  
Operation Type:

- Momentary
- Maintained(Z)

Lamp type: Flat illuminated (LED)  
The Front Shape: Flat  
The Crust Material: Stainless steel  
IP Degree: IP67, IK10

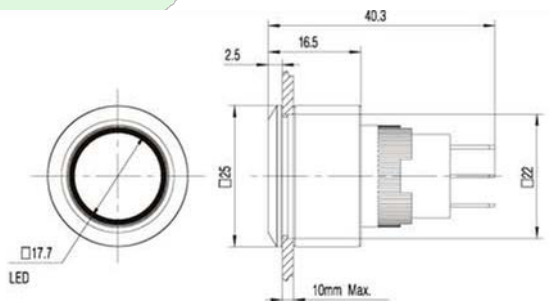



Ø 22 -25 mm

TOPTEK®  
HARDWARE ELECTRONIC MANUFACTURER



## I-TOP-S1-AWP



Diameter: Ø 22mm  
Color: R, G, Y, O, B, W  
Switch Rating: 5A/250VAC  
Contact Configuration:  
1NO 1NC /2NO 2NC  
Operation Type:  

- Momentary
- Maintained(Z)

 Lamp type:  
Power symbol illuminated (LED)  
The Front Shape: Flat  
The Crust Material: Stainless steel  
IP Degree: IP67, IK10

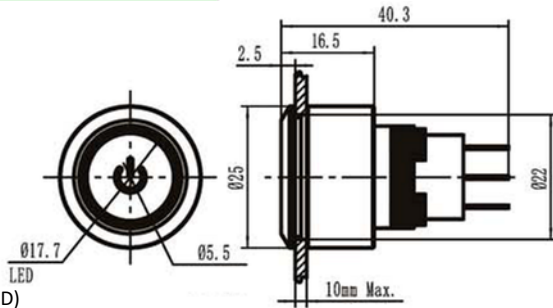

14  
\*  
59

## S-TOP-25F



Diameter: Ø 25mm  
Switch Rating: 5A/250VAC  
Contact Configuration:  
1NO 1NC /2NO 2NC  
Operation Type:  

- Momentary
- Maintained(Z)

 The Front Shape: Flat  
The Crust Material: Stainless steel  
IP Degree: IP67, IK10

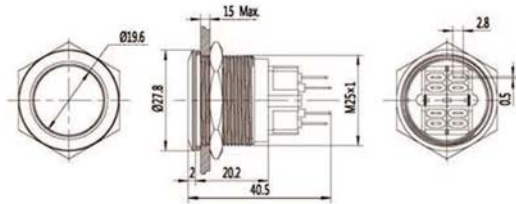

## S-TOP-25B



Diameter: Ø 25mm  
Switch Rating: 5A/250VAC  
Contact Configuration:  
1NO 1NC /2NO 2NC  
Operation Type:  

- Momentary
- Maintained(Z)

 The Front Shape: Ball  
The Crust Material: Stainless steel  
IP Degree: IP67, IK10

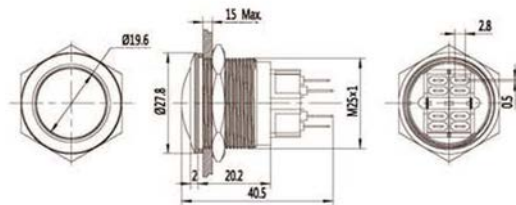

## S-TOP-25H



Diameter: Ø 25mm  
Switch Rating: 5A/250VAC  
Contact Configuration:  
1NO 1NC /2NO 2NC  
Operation Type:  

- Momentary
- Maintained(Z)

 The Front Shape: High  
The Crust Material: Stainless steel  
IP Degree: IP67, IK10

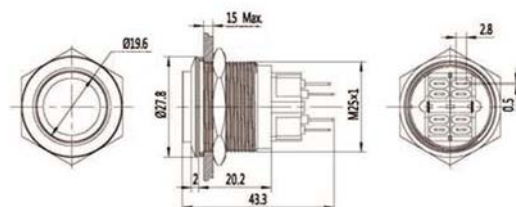

# CONNECTOR MANUFACTURERS

TOPTEK®  
HARDWARE ELECTRONIC MANUFACTURER

www.toptek-co.com

## Ø 25 - 28 mm

### S-TOP-25F-E



Diameter: Ø 25mm  
Color: R, G, Y, O, B, W  
Switch Rating: 5A/250VAC  
Contact Configuration:  
1NO 1NC/2NO 2NC  
Operation Type:

- Momentary
- Maintained(Z)

The Front Shape: Flat  
Lamp type: Ring illuminated (LED)  
The Crust Material: Stainless steel  
IP Degree: IP67, IK10

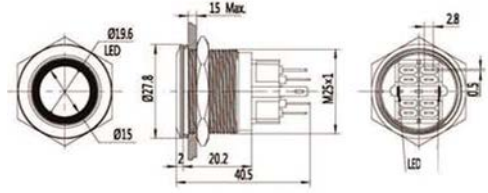

### S-TOP-25F-D



Diameter: Ø 25mm  
Color: R, G, Y, O, B, W  
Switch Rating: 5A/250VAC  
Contact Configuration:  
1NO 1NC/2NO 2NC  
Operation Type:

- Momentary
- Maintained(Z)

The Front Shape: Flat  
Lamp type: Dot illuminated (LED)  
The Crust Material: Stainless steel  
IP Degree: IP67, IK10

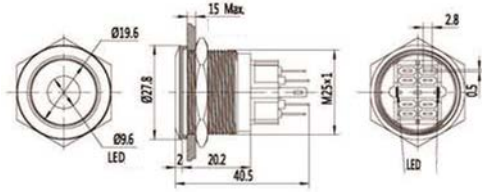

### S-TOP-25F-EP



Diameter: Ø 25mm  
Color: R, G, Y, O, B, W  
Switch Rating: 5A/250VAC  
Contact Configuration:  
1NO 1NC/2NO 2NC  
Operation Type:

- Momentary
- Maintained(Z)

The Front Shape: Flat  
Lamp type: Power symbol illuminated (LED)  
The Crust Material: Stainless steel  
IP Degree: IP67, IK10

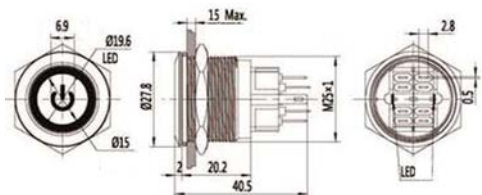

### S-TOP-28F



Diameter: Ø 28mm  
Switch Rating: 5A/250VAC  
Contact Configuration:  
1NO 1NC /2NO 2NC  
Operation Type:

- Momentary
- Maintained(Z)

The Front Shape: Flat  
The Crust Material: Stainless steel  
IP Degree: IP67, IK10

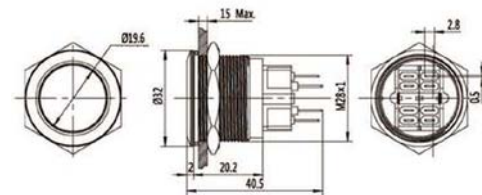

14  
\*  
60

Anti-vandal Switch

Pb

ROHS

Ø 28 mm

**TOPTTEK®**  
HARDWARE ELECTRONIC MANUFACTURER



## S-TOP-28B



Diameter: Ø 28mm  
 Switch Rating: 5A/250VAC  
 Contact Configuration:  
 1NO 1NC /2NO 2NC  
 Operation Type:  
 • Momentary  
 • Maintained(Z)  
 The Front Shape: Ball  
 The Crust Material: Stainless st  
 IP Degree: IP67, IK10

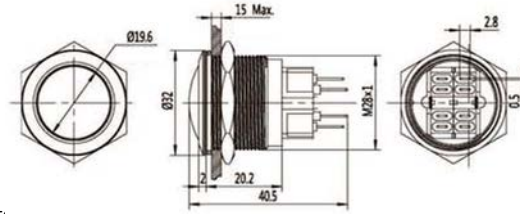

14  
\*  
61

## S-TOP-28H



Diameter: Ø 28mm  
 Switch Rating: 5A/250VAC  
 Contact Configuration:  
 1NO 1NC /2NO 2NC  
 Operation Type:  
 • Momentary  
 • Maintained(Z)  
 The Front Shape: Flat  
 The Crust Material: Stainless steel  
 IP Degree: IP67, IK10

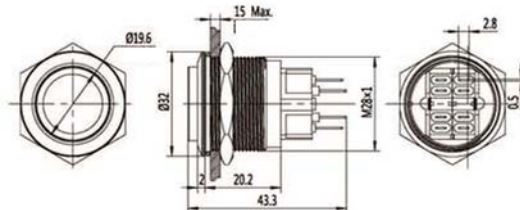

## S-TOP-28F-E



Diameter: Ø 28mm  
 Color: R, G, Y, O, B, W  
 Switch Rating: 5A/250VAC  
 Contact Configuration:  
 1NO 1NC /2NO 2NC  
 Operation Type:  
 • Momentary  
 • Maintained(Z)  
 Lamp type: Ring illuminated (LED)  
 The Front Shape: Flat  
 The Crust Material: Stainless steel  
 IP Degree: IP67, IK10

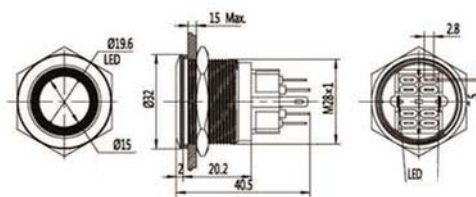

## S-TOP-28F-D



Diameter: Ø 28mm  
 Switch Rating: 5A/250VAC  
 Contact Configuration:  
 1NO 1NC /2NO 2NC  
 Operation Type:  
 • Momentary  
 • Maintained(Z)  
 Lamp type: Dot illuminated (LED)  
 The Front Shape: Flat  
 The Crust Material: Stainless steel  
 IP Degree: IP67, IK10

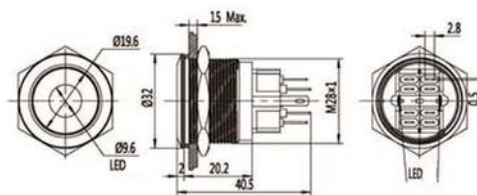

# CONNECTOR MANUFACTURERS

TOPTEK®  
HARDWARE ELECTRONIC MANUFACTURER

www.toptek-co.com

## Ø 28 - 30 mm

### S-TOP-28F-EP



Diameter: Ø 28mm  
Color: R, G, Y, O, B, W  
Switch Rating: 5A/250VAC  
Contact Configuration:  
1NO 1NC/2NO 2NC  
Operation Type:

- Momentary
- Maintained(Z)

The Front Shape: Flat  
Lamp type: Power symbol illuminated (LED)  
The Crust Material: Stainless steel  
IP Degree: IP67, IK10

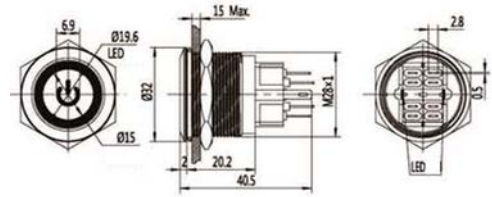

### S-TOP-30F



Diameter: Ø 30mm  
Switch Rating: 5A/250VAC  
Contact Configuration:  
1NO 1NC/2NO 2NC  
Operation Type:

- Momentary
- Maintained(Z)

The Front Shape: Flat  
The Crust Material: Stainless steel  
IP Degree: IP67, IK10

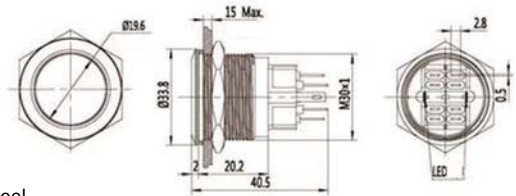

### S-TOP-30F-D



Diameter: Ø 30mm  
Color: R, G, Y, O, B, W  
Switch Rating: 5A/250VAC  
Contact Configuration:  
1NO 1NC/2NO 2NC  
Operation Type:

- Momentary
- Maintained(Z)

The Front Shape: Flat  
Lamp type: Dot illuminated (LED)  
The Crust Material: Stainless steel  
IP Degree: IP67, IK10

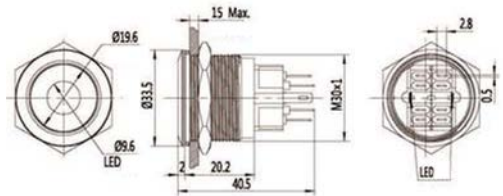

### S-TOP-30F-E



Diameter: Ø 30mm  
Switch Rating: 5A/250VAC  
Contact Configuration:  
1NO 1NC /2NO 2NC  
Operation Type:

- Momentary
- Maintained(Z)

The Front Shape: Flat  
Lamp type: Ring illuminated (LED)  
The Crust Material: Stainless steel  
IP Degree: IP67, IK10

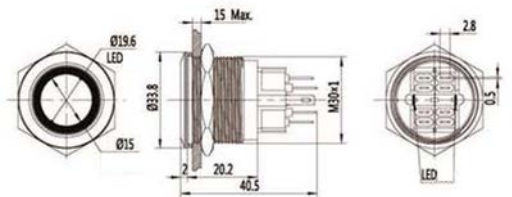



Ø 40 mm

TOPTTEK®  
HARDWARE ELECTRONIC MANUFACTURER



www.toptek-co.com

## S-TOP-40F



Diameter: Ø 40mm  
Switch Rating: 5A/250VAC  
Contact Configuration:  
1NO 1NC /2NO 2NC  
Operation Type:

- Momentary
- Maintained(Z)

The Front Shape: Flat  
The Crust Material: Stainless steel  
IP Degree: IP67, IK10

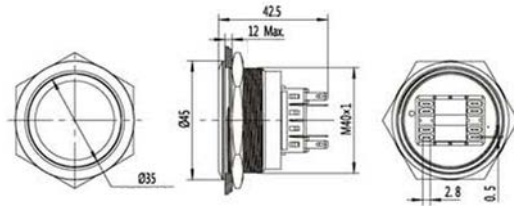

## S-TOP-40B



Diameter: Ø 40mm  
Switch Rating: 5A/250VAC  
Contact Configuration:  
1NO 1NC /2NO 2NC  
Operation Type:

- Momentary
- Maintained(Z)

The Front Shape: Ball  
The Crust Material: Stainless steel  
IP Degree: IP67, IK10

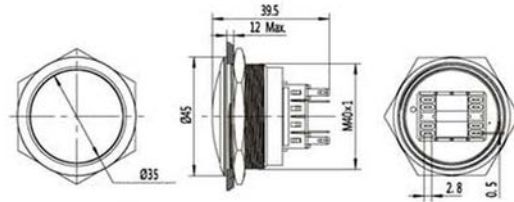

## S-TOP-40H



Diameter: Ø 40mm  
Switch Rating: 5A/250VAC  
Contact Configuration:  
1NO 1NC /2NO 2NC  
Operation Type:

- Momentary
- Maintained(Z)

The Front Shape: High  
The Crust Material: Stainless steel  
IP Degree: IP67, IK10

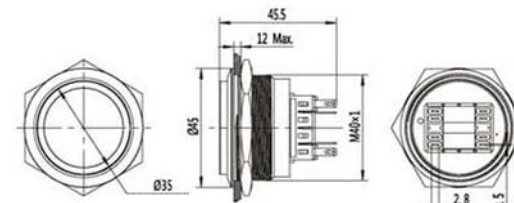

## S-TOP-40F-E



Diameter: Ø 40mm  
Color: R, G, Y, O, B, W  
Switch Rating: 5A/250VAC  
Contact Configuration:  
1NO 1NC /2NO 2NC  
Operation Type:

- Momentary
- Maintained(Z)

Lamp type: Ring illuminated (LED)  
The Front Shape: Flat  
The Crust Material: Stainless steel  
IP Degree: IP67, IK10

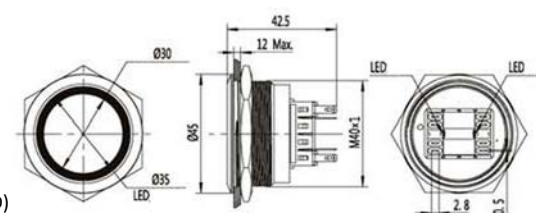

14  
\*  
63





# CONNECTOR MANUFACTURERS

**TOPTTEK®**  
HARDWARE ELECTRONIC MANUFACTURER

 www.toptek-co.com

## Accessories & Custom Parts

TOP-DC16

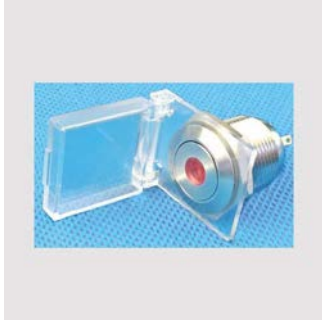

Dustproof Cover for 16mm Switch

TOP-DC19

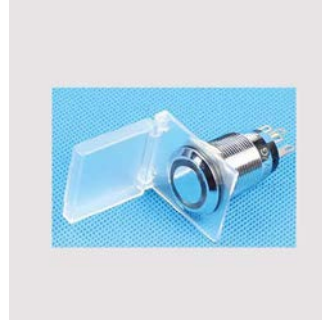

Dustproof Cover for 19mm Switch

TOP-DC22



Dustproof Cover for 22mm Switch

TOP-HS-1-2-3

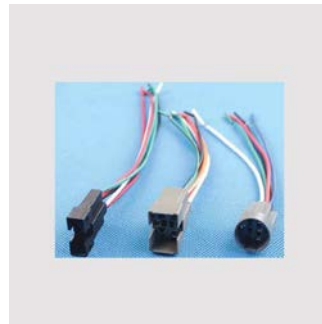

Harness for Switches

## Parts of the Custom Product Display



14  
\*  
64

Anti-vandal Switch



ROHS