

CONNECTOR MANUFACTURERS

Rating: 10A 125VAC ; 6A 250VAC
 Contact Resistance: 35m Ω max
 Insulation Resistance: 500VDC 100M Ω min

Dielectric Strength: 1500VAC, 1 Minute
 Operating Temperature: -25°C~ +85°C
 Electrical Life: ≥ 10,000 Cycles

TOPTEK®
 HARDWARE ELECTRONIC MANUFACTURER

www.toptek-co.com

A-TOP1-5-101 EN

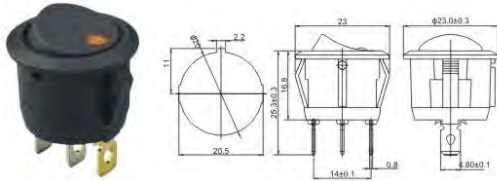

A-TOP1-5-101EN ON-OFF

A-TOP1-8-101

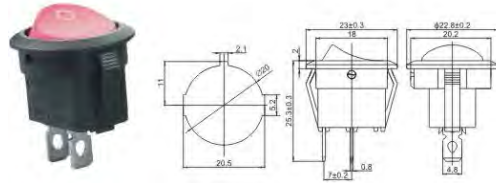

A-TOP1-8-101 ON-OFF

A-TOP1-5-101H/102H/103H/101NH

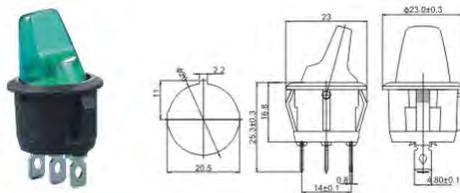

A-TOP1-5-101H ON-OFF
 A-TOP1-5-102H ON-ON
 A-TOP1-5-103H ON-OFF-ON
 A-TOP1-5-101NH ON-OFF

A-TOP1-8-102 / 103

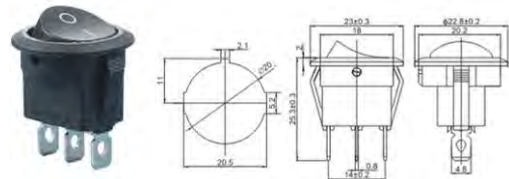

A-TOP1-8-102 ON-ON
 A-TOP1-8-103 ON-OFF-ON

A-TOP1-8-101N

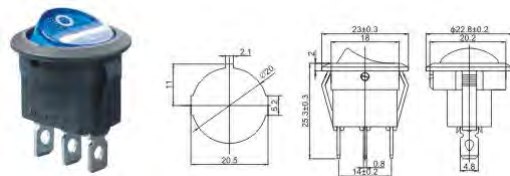

A-TOP1-8-101N ON-OFF

A-TOP1-02



A-TOP1-02

A-TOP1-8-101EN

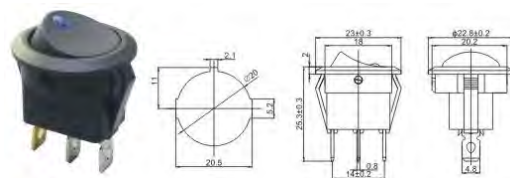

A-TOP1-8-101EN ON-OFF

A-TOP1-6-201

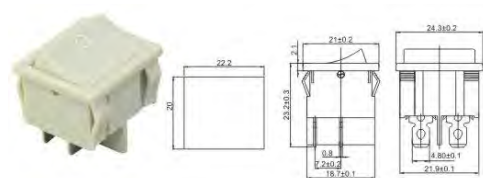

A-TOP1-6-201 ON-OFF