

MODEL NO.:B2418A
 Dimensions(mm):23.8x16
 Operating Voltage(VDC): 3~20
 Resonant Freq.(Hz):2800
 SPL(dB):90min at 10cm
 Tone: continuous

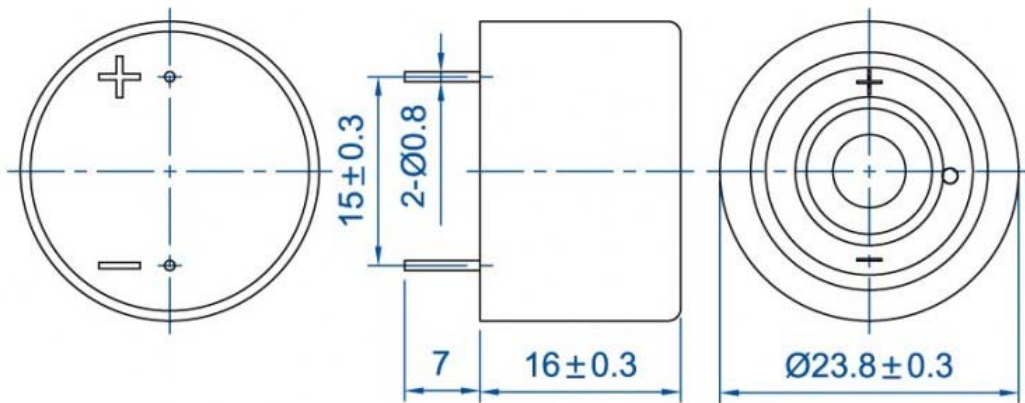

Model	Model	B2418A-TB-12-2.8-15.0-R
2	Rated Voltage (VDC)	12
3	Operating Voltage (VDC)	3~20
4	*Rated Current (mA)	≤25

5	*Sound Output at 10 cm (dB)	≥90
6	*Resonant Frequency (Hz)	2800±500
7	Operating Temperature (°C)	-20~+65
8	Storage Temperature (°C)	-30~+75
9	Weight (g)	5.4
10	Housing Material	PBT
11	RoHS	Yes
